



Alumil

Alumil  SUPREME
S650 PHOS

PHOS means Light PHOS inseamna Lumina

“Architecture is the learned game, correct and magnificent, of forms assembled in the light.”

“Arhitectura este jocul invatat, corect si uimitor, al formelor asamblate in lumina.”

Le Corbusier

Feel like living outdoors

Sentimentul absolut al libertatii

SUPREME S650 PHOS is the ideal choice for sliding windows with wide glazing surfaces mounted in aluminium frames that are totally flush to the ceiling and the floor. Thus, the system offers to the users the sense of freedom and direct interaction with the external environment. SUPREME S650 PHOS can be operated either manually or automatically (version SUPREME S650 e-MOTION).

SUPREME S650 PHOS este alegerea ideala pentru ferestre glisante, cu suprafete vitrate ample, cu rame de aluminiu, complet ascunse in pardoseala sau in tavan. Asadar, sistemul ofera clientilor sentimentul absolut al libertatii si interactiunea directa cu mediul extern. SUPREME S650 PHOS poate fi operat manual sau poate fi automatizat (versiunea SUPREME S650 e-MOTION).

SUPREME S650 PHOS

DESIGN PHILOSOPHY & CHARACTERISTICS
CARACTERISTICI & FILOSOFIA DESIGN-ULUI 4

SENSE OF FREEDOM
SENTIMENTUL LIBERTATII 6

ATTENTION TO DETAIL
ATENTIE LA DETALII 8

ATTENTION TO SAFETY
ATENTIE PENTRU SIGURANTA 10

SECTIONS
SECTIUNI 12

SUPREME S650 e-MOTION

FUNCTIONALITY, CREDIBILITY AND COMFORT
FUNCTIONALITATE, INCREDERE SI CONFORT 22

SECTIONS
SECTIUNI 24

APPLICATIONS
APLICATII 28

PERFORMANCE
PERFORMANTE 30



ALUMIL's sliding thermal insulating system SUPREME S650 PHOS is the ideal solution for projects requiring wide spans with minimal aluminium site lines. Wide yet elegant glazing surfaces are achieved while maintaining high functionality, performances and minimal architectural design.

- / All the aluminum profiles are totally concealed in wall so as to maximize natural light.
- / Only 25 mm visible aluminium face width at the interlocking profile.
- / Extra concealed profiles available for water drainage.
- / Stainless steel rollers for smooth sliding & maximum functionality with high tolerance in corrosion.
- / For all parallel sliding typologies including the corner constructions.
- / Special profiles for the implementation of multi-sash typologies.
- / Alternative version for top-mounted installation.

Technical characteristics

Visible aluminium face width	Concealed profiles
Frame height	59 mm
Frame width	164 mm
Sash height	22/32 mm
Sash width	62 mm
Interlocking profile width	25 mm
Sash weight	Up to 600 Kg
Glazing	46 mm
Insulation	Polyamides, PVC

Sistemul ALUMIL cu bariera termica, SUPREME S650 PHOS, este solutia ideala pentru proiecte ce necesita deschideri ample, cu linii fine, minimaliste, de aluminiu. Suprafetele vitrate elegante si ample sunt obtinute, pastrand functionalitatea ridicata si un design arhitectural minimalist.

- / Toate profilele (toc si cercevea) de aluminiu sunt complet incastrate in perete, pentru a maximiza volumul de lumina naturala ce patrunde in interior.
- / Suprafata de aluminiu vizibila, in zona de cuplare centrala, de doar 25 mm.
- / Profile suplimentare pentru drenajul apei, incastrate.
- / Role din otel inoxidabil pentru glisare lina si functionalitate maximizata, cu rezistenta crescuta la coroziune.
- / Pentru toate tipologiile glisante, inclusiv constructiile in colt liber.
- / Profile speciale pentru implementarea tipologiilor cu cercevele multiple.
- / Versiune alternativa pentru instalarea deasupra pardoselei.

Caracteristici tehnice

Suprafata de aluminiu vizibila minima	Profile ascunse
Inaltime toc	59 mm
Latime toc	164 mm
Inaltime cercevea	22/32 mm
Latime cercevea	62 mm
Latimea zonei de by-pass	25 mm
Greutate cercevea	Pana la 600 Kg
Vitrare	46 mm
Izolare	Poliamida, PVC

Sense of freedom
Sentimentul libertatii



The system's main advantage is the improvement of living conditions by maximizing the natural lighting and minimizing the visible aluminum face width, which makes the residents feel closer to the external environment and increases their sense of freedom.

The limits between interior and exterior are eliminated, as the only visible aluminium width is 25 mm at the interlocking profile.

In addition, the reinforced interlocking profile apart from aesthetics and functionality, offers robustness to the structure and resistance to wind loads for higher sashes.

Avantajul principal al sistemului este imbunatatirea conditiilor de locuire, prin maximizarea luminii naturale si minimizarea suprafetei vizibile de aluminiu, ceea ce aduce rezidentii mai aproape de mediul extern si intensifica sentimentul libertatii.

Limitele dintre interior si exterior sunt eliminate, suprafata de aluminiu vizibila fiind de doar 25 mm, in zona profilului de cuplare.

Mai mult decat atat, profilul de cuplare ranforsat, pe langa estetica si functionalitate, ofera soliditate structurii si rezistenta la incarcările din vant, pentru cercevele de dimensiuni mai mari.



Attention to detail
Atentie la detalii



SUPREME S650 PHOS offers a unique combination of elegance and functionality, satisfying even the most demanding requirements.

Its minimal design along with the wide glazing surfaces enhance maximum visibility and natural light by using TOTALLY concealed profiles into the walls, the floor and the ceiling.

SUPREME S650 PHOS ofera o combinatie unica de eleganta si functionalitate, multumind si cele mai solicitante cerinte.

Design-ul sau minimalist, alaturi de suprafetele vitrate ample, imbunatatesc vizibilitatea si sporesc volumul de lumina naturala, prin utilizarea profilelor complet incastrate in perete, podea sau tavan.

Alternative version for top-mounted installation with a low threshold, a flat track that is addressing safety issues for easy and safe access to children, elders and people with special needs.

A more flexible solution ideal for renovations with innovative water drainage.

Versiunea alternativa, pentru montare deasupra pardoselei, cu prag de dimensiuni reduse, o cale de rulare plata, ideala pentru accesul copiilor, varstnicilor si persoanelor cu nevoi speciale.

Sistemul reprezinta o solutie flexibila pentru renovari, beneficiind de un drenaj inovator al apei.

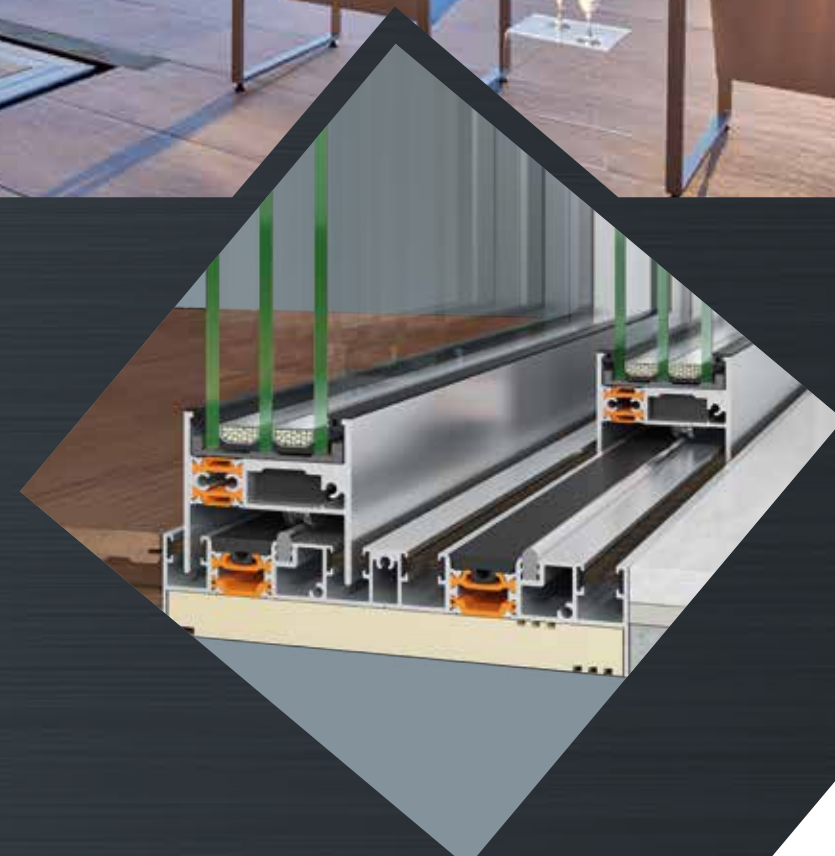

Attention to safety
Atentie pentru siguranta



Handles

ALUMIL handles with unique design offer high security as they are lockable with key placed on the handle level. In addition, they are very easy to install after transportation on site and can be easily removed for maintenance.

Manere

Manerele ALUMIL, cu design unic, ofera un grad ridicat de siguranta si pot fi incuiate cu cheie, la nivelul manerului. Mai mult decat atat, sunt usor de instalat, dupa transportul la locatie si pot fi cu usurinta demontate, pentru mentenanta.

Rollers

Stainless steel rollers, ideal for seaside projects. For heavy duty constructions up to 600 Kg per sash, offering high functionality & smooth gliding of the sashes.

Certified performances tested according EN 13126-1 and EN 1670 for:

✓ Corrosion resistance / Durability
✓ Static load / Hardness

Role

Role din otel inoxidabil, ideale pentru proiecte din zonele de coasta. Este ideal pentru constructii ce sustin pana la 600 Kg pe canat, oferind un nivel ridicat de functionalitate si o glisare lina a cercevelor.

Performante certificate, in conformitate cu EN 13126-1 si EN 1670 pentru:

✓ Rezistenta la coroziune / Durabilitate
✓ Incarcare statica / Duritate

Locking system

Locking system is very sophisticated and yet very robust engineered, offering multiple point locking, top-bottom with rod and on the vertical fixed frame with bolts and strikers.

Sistemul de inchidere

Sistemul de inchidere este foarte sofisticat si totusi robust, oferind multiple puncte de bloare: sus-jos, cu tija iar pe tocul vertical cu bolturi si contraplaci.

Shading and insect protection

The minimal series SUPREME S650 PHOS is compatible with the automated vertical screen for shading or insect protection, which is ideal for wide spans of up to 6 m width and does not restrict the sight view.

It offers efficient protection against insects and includes a new technology that retains the insect-screen completely stretched for flawless operation over time.

Umbrire si protectie contra insectelor

Seria minimalista SUPREME S650 PHOS este compatibila cu sistemul automatizat vertical pentru umbrire sau protectie contra insectelor, ideal pentru deschideri largi, de pana la 6 m latime si nu obtureaza cu nimic panorama.

Ofera protectie eficienta contra insectelor si include o noua tehnologie, ce pastreaza plasa contra insectelor complet intinsa pentru o functionare fara probleme in timp.



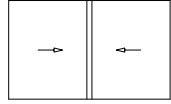

The innovative design of the concealed water drainage system offers excellent performance even under adverse weather conditions. Specially perforated profiles and accessories, assembled together, facilitate the water outflow.

Design-ul inovator al sistemului ascuns de drenare a apei ofera performante excelente, chiar si in conditii climatice extreme. Profile si accesorii perforate special, asamblate impreuna, faciliteaza scurgerea apei.

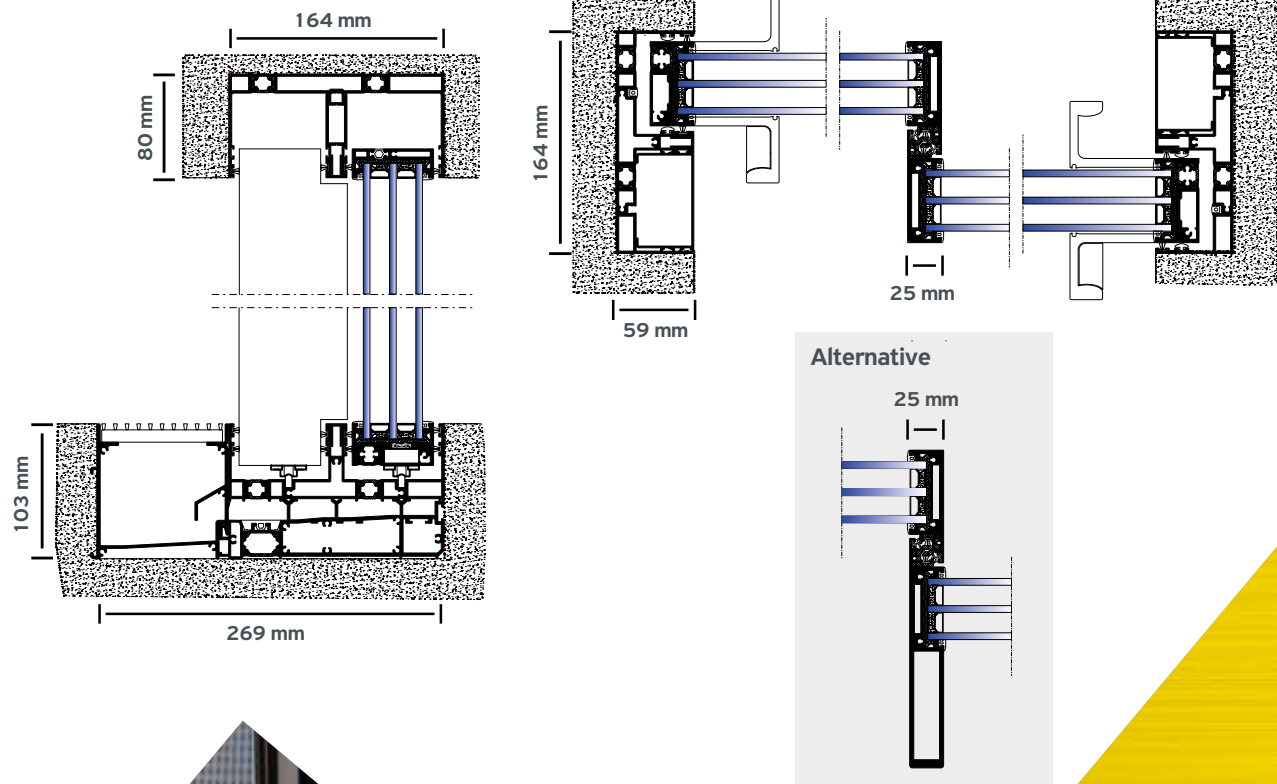

2 cercevele / 2 cai de rulare
 prag de dimensiuni reduse
 2 sashes / 2 track
 low threshold

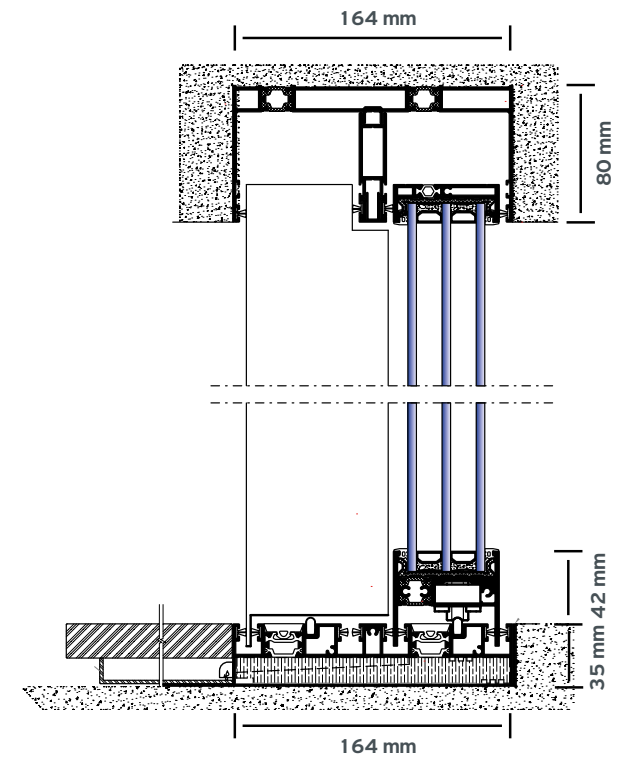
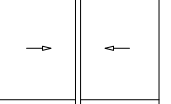

Even when the low threshold is selected for top-mounted installation, there is a special component for the concealed water drainage that offers high watertightness.

Chiar atunci cand se opteaza pentru pragul de dimensiuni reduse pentru montarea deasupra pardoselei, exista o componenta speciala, pentru drenarea ascunsa a apei, ce ofera o etanseitate ridicata.

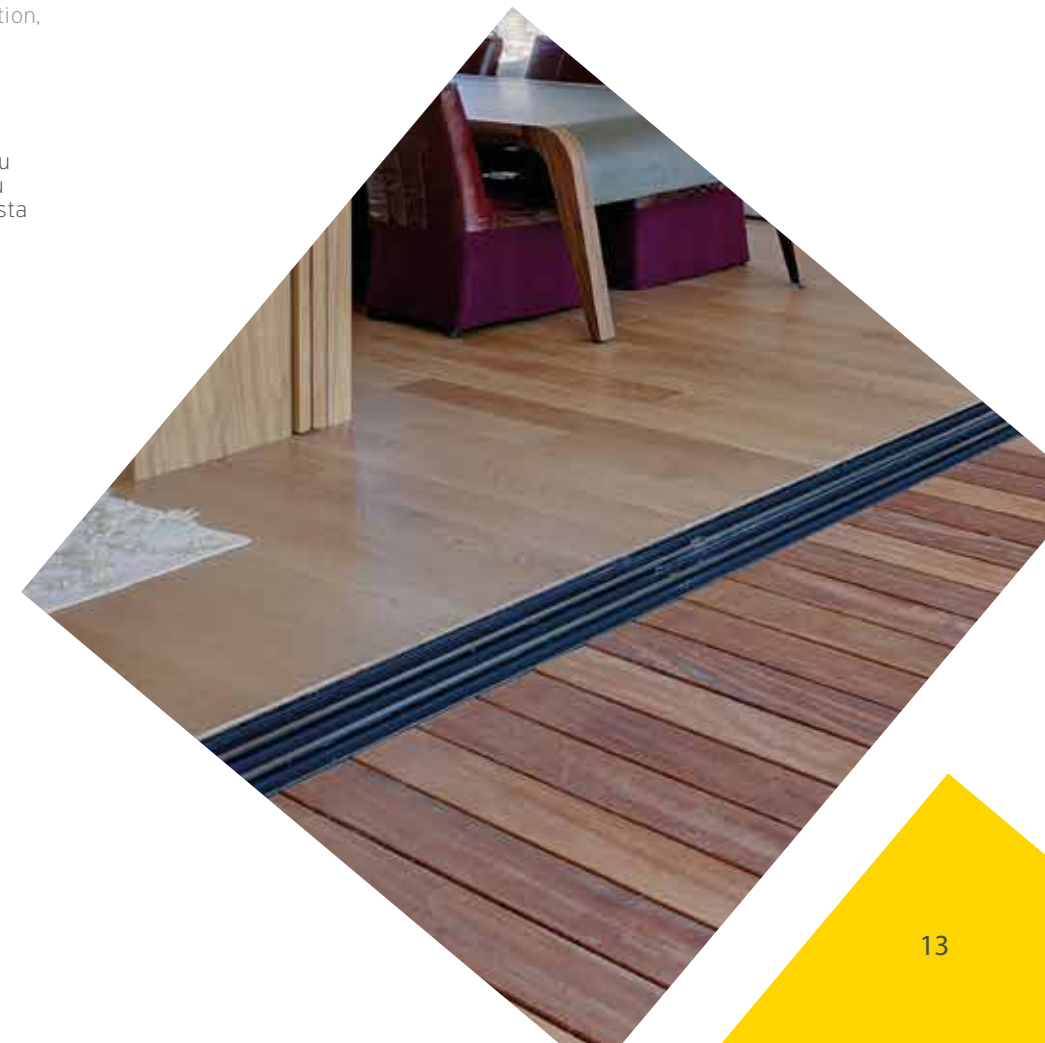

2 sashes / 2 track
 2 cercevele / 2 cai de rulare

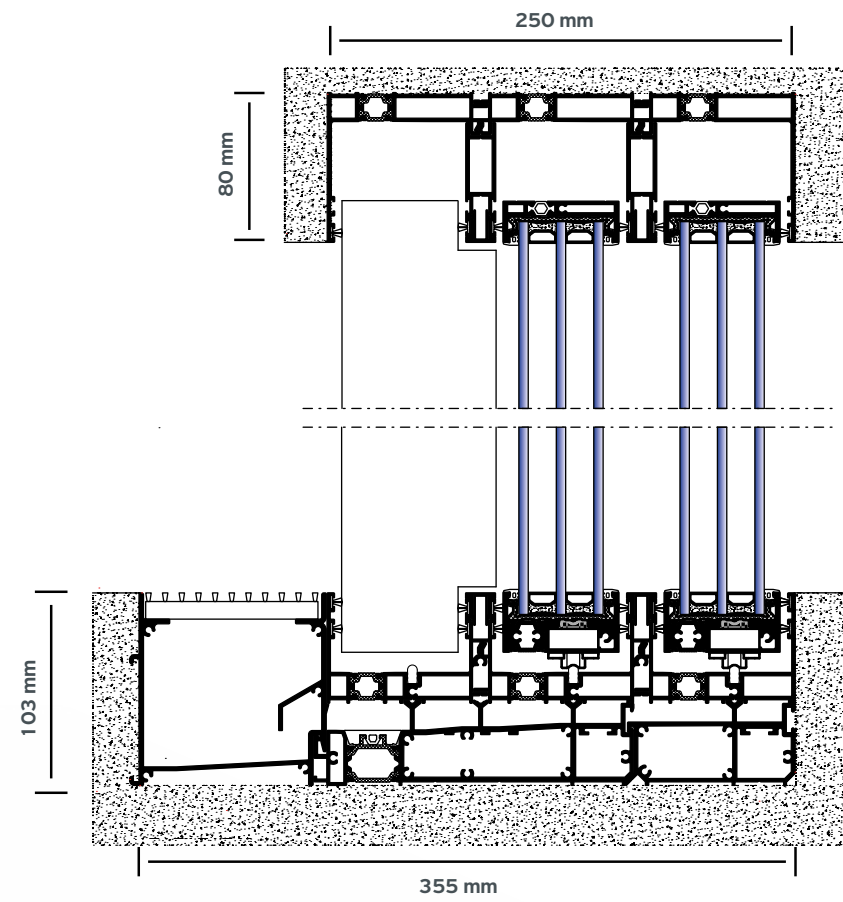
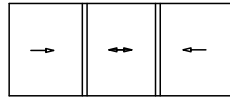

3 cercevele / 3 cai de rulare
 prag de dimensiuni reduse
 3 sashes / 3 track
 low threshold

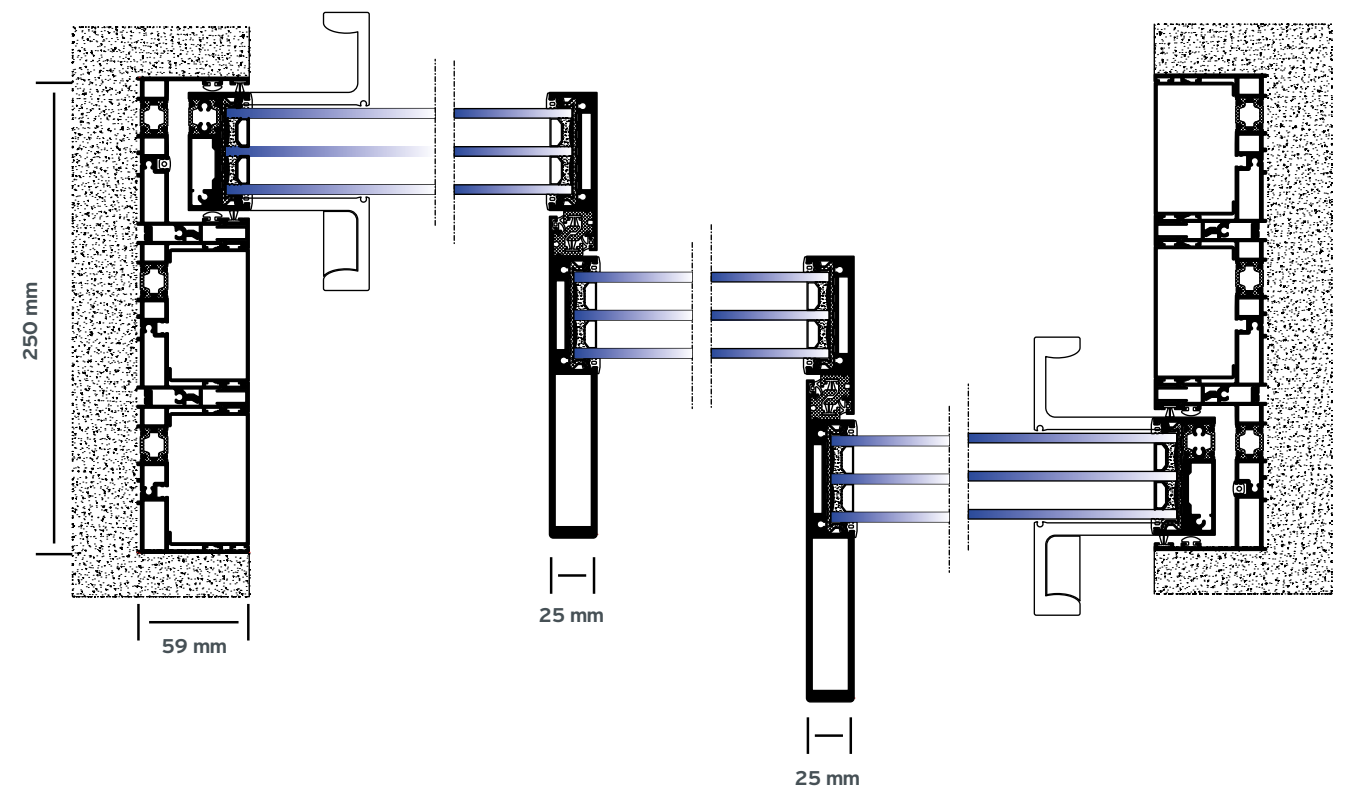
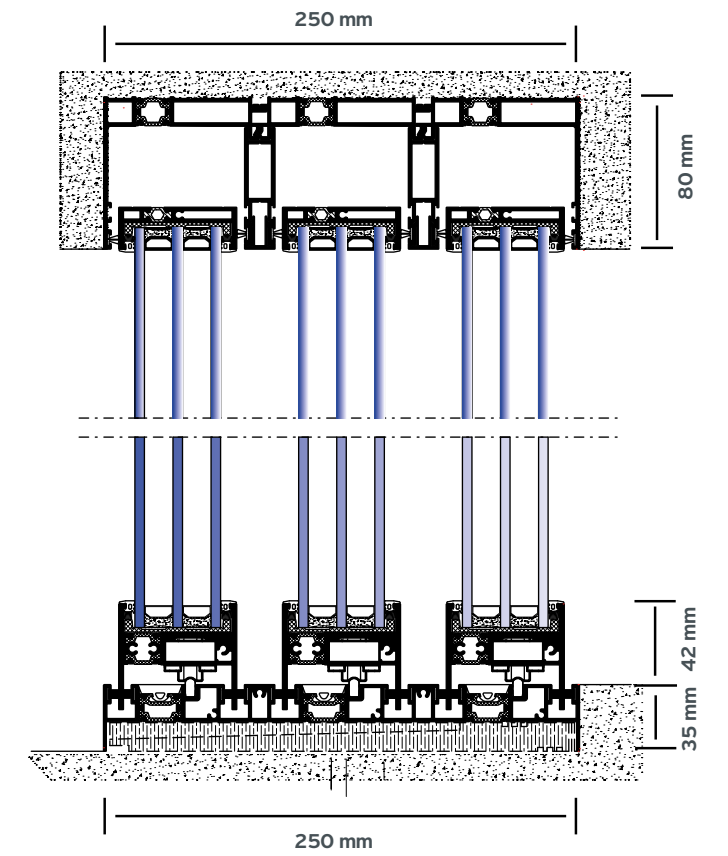
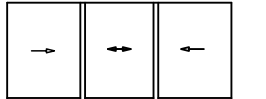

3 sashes / 3 track
 3 cercevele / 3 cai de rulare

Multi track

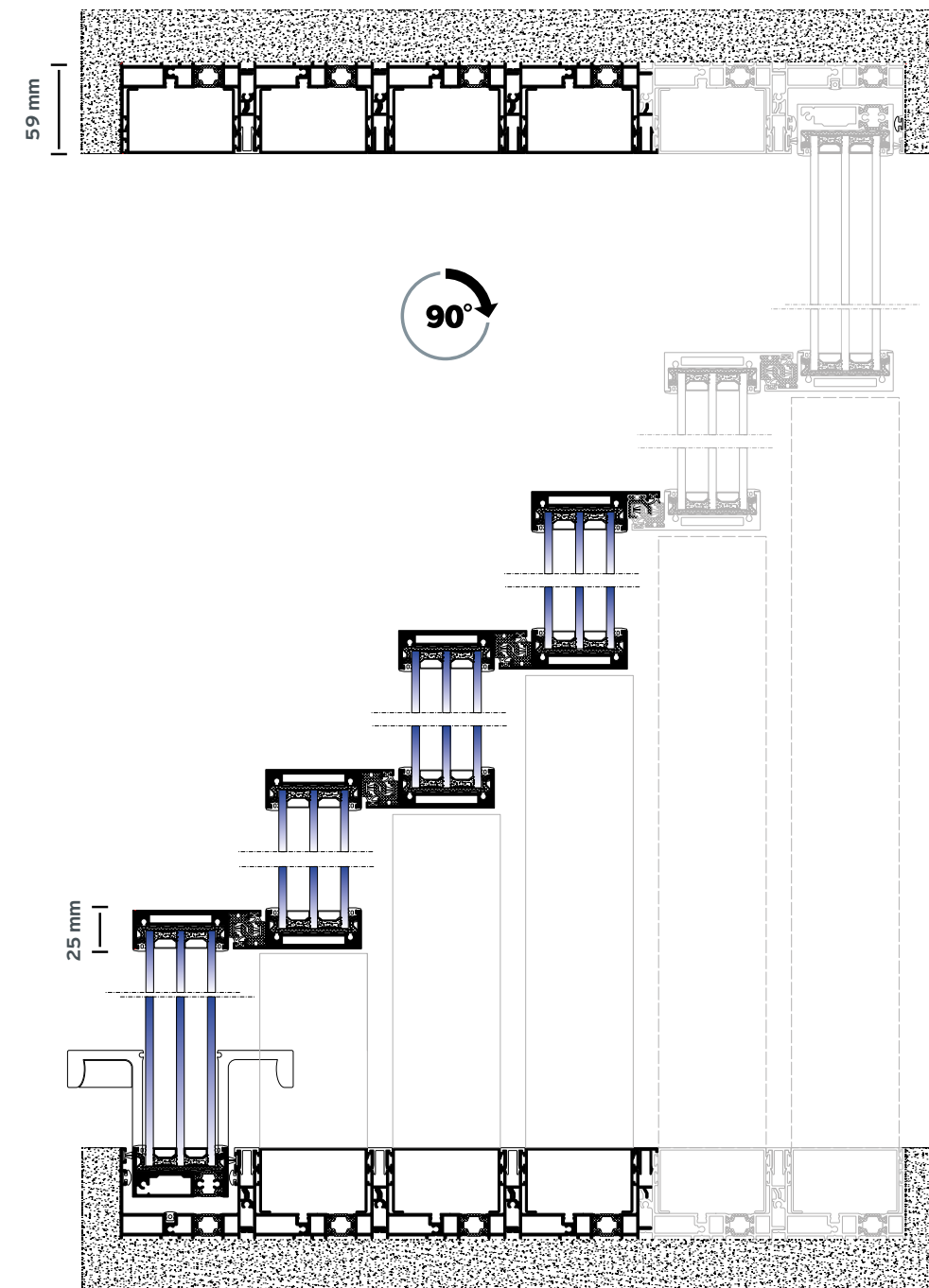
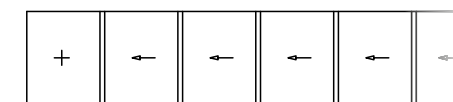
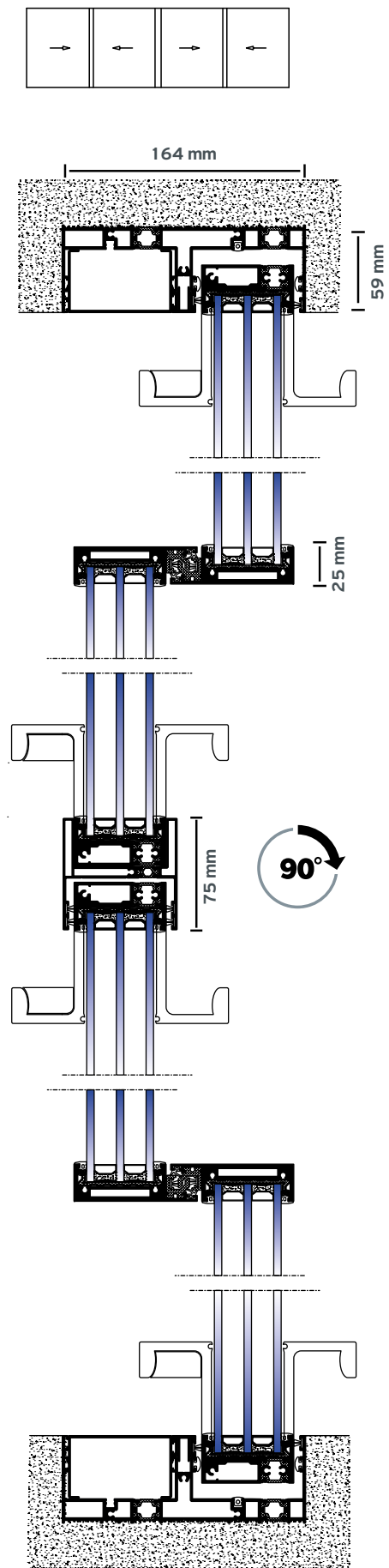

In order to cover wide spans, SUPREME S650 PHOS offers the ability of implementing multiple tracks with the specially designed profiles of the series.

Thus, the main advantage of the multi-sash typologies is that there is no limit at the number of the horizontal sliding sashes.

Pentru a acoperi deschideri largi, SUPREME S650 PHOS ofera posibilitatea implementarii cailor de rulare multiple, cu profile special proiectate.

Asadar, avantajul principal al tipologiilor cu cercevele multiple este acela ca nu exista nicio limitare a numarului de canate glisante orizontale.

4 sashes / 2 track
4 cercevele / 2 cai de rulare

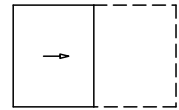

1 cercevea / 1 cale de rulare
1 sash / 1 track

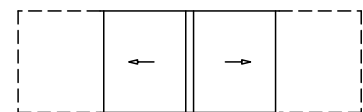
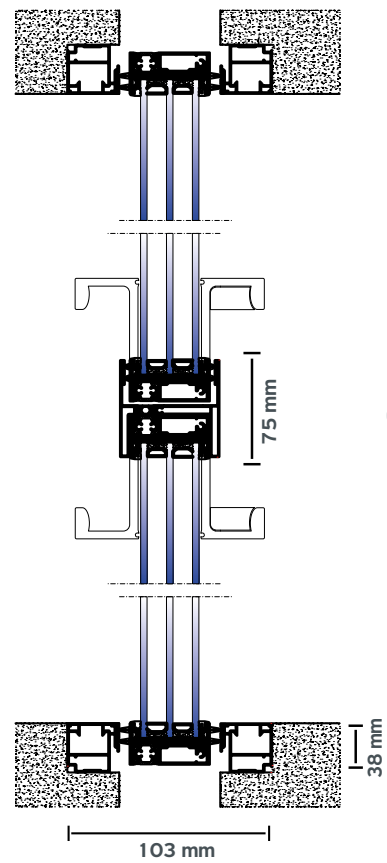
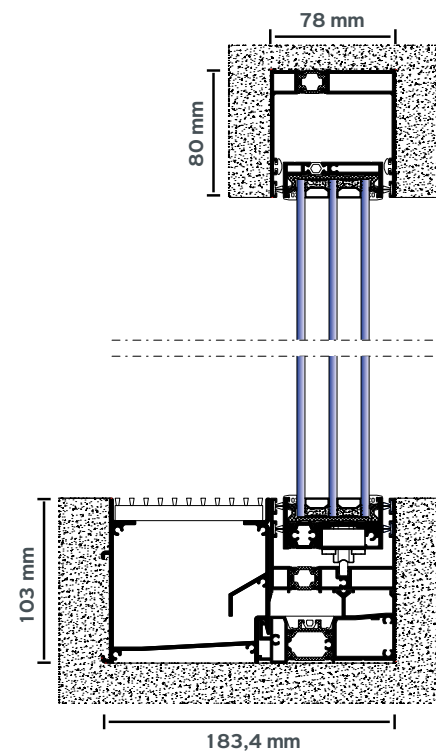
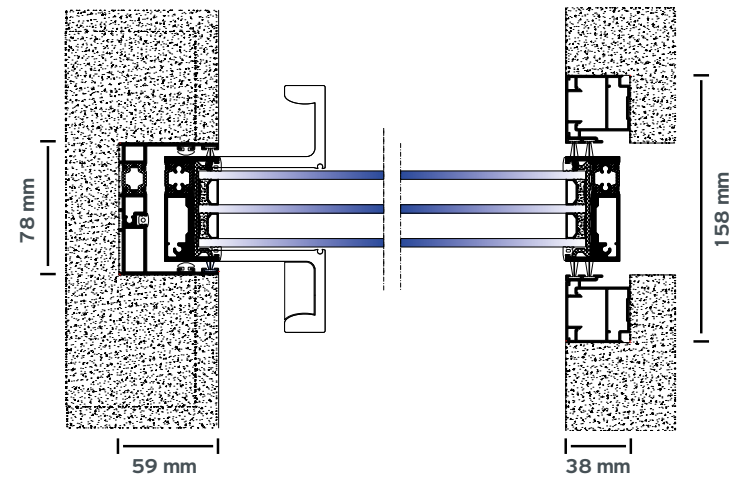

2 cercevele / 1 cale de rulare
2 sashes / 1 track



Pocket window
1 sash / 1 track
2 sashes / 1 track

Fereastra retractabila in zid
1 cercevea / 1 cale de rulare
2 cercevele / 1 cale de rulare

Fereastra retractabila in zid
Multi track

Pocket window
Multi track

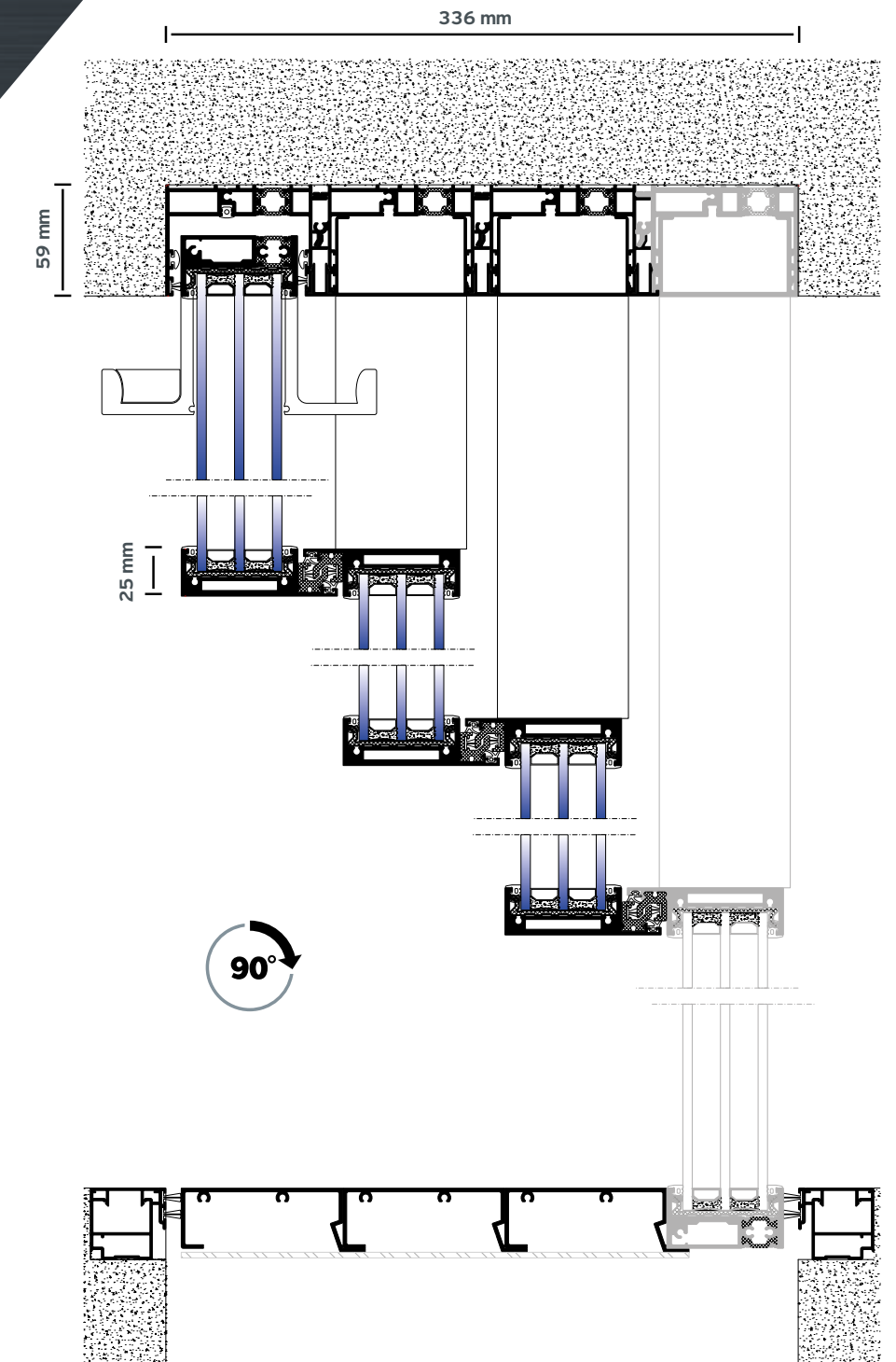

Colt exterior
External Corner

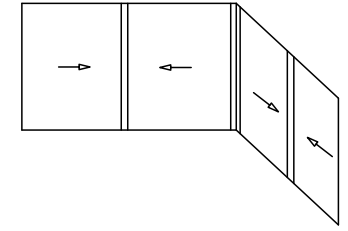

- Corner constructions without using intermediate mullions offer:
- / Maximum natural lighting.
 - / Ease of access.
 - / Minimal design.
 - / High functionality.

- Construcții în colț liber, fără utilizarea montanților intermediari, oferă:
- / Sporirea volumului de lumină naturală.
 - / Facilitarea accesului.
 - / Design minimalist.
 - / Funcționalitate ridicată.

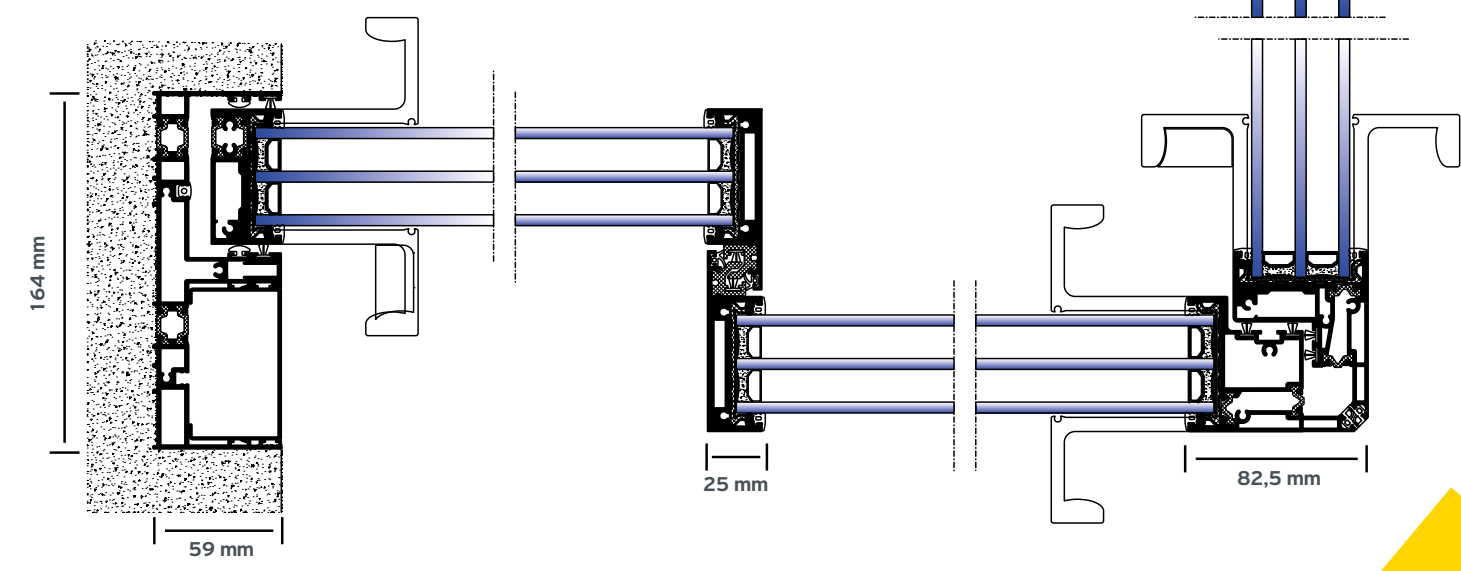
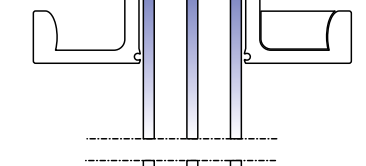
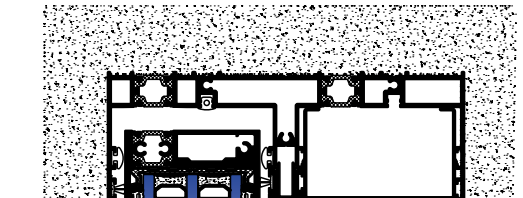



Automated version

The SUPREME S650 e-MOTION is the automated version of the SUPREME S650 PHOS series. The elegant design and the electrical automation offering maximum ease of use, make it the perfect solution for projects that require impressive wide spans with uninterrupted view, as well as perfect comfort.

The innovative design of the system with the concealed mechanism, ensure the smooth motion of the system with emphasis on safety and functionality.

- / All the aluminum profiles are totally concealed in wall so as to maximize natural lighting.
- / Remote controlled electric motion for ease of use.
- / Maximum safety through a central control system (motion sensors, electromagnetic locking and fire detection), which is compatible with smart house applications.
- / Narrow interlocking profile with only 25 mm visible aluminum face width.
- / Can be operated in case of blackout thanks to the integrated rechargeable battery.
- / Manual operation possible in case of emergency.
- / Extra concealed profiles available for water drainage.

Technical characteristics

	Concealed profiles
Visible aluminium face width	
Frame height	45 mm
Frame width	174 mm
Sash height	25/32 mm
Sash width	67,4 mm
Interlocking profile width	25 mm
Sash weight	Up to 700 Kg
Glazing	52 mm
Insulation	Polyamides, PVC

Versiunea automatizata

SUPREME S650 e-MOTION este versiunea automatizata a sistemului SUPREME S650 PHOS. Design-ul elegant și superioritatea manevrării electrice fac din acest sistem soluția ideală pentru proiecte ce necesită deschideri ample, funcționalitate perfectă, confort și niciun fel de restricții privind panorama rezidenților.

Design-ul inovator al tipologiilor sistemului S650 automatizat, în combinație cu mecanismul ascuns, asigură deplasarea lină a sistemului, cu accent pe siguranța și funcționalitate.

- / Toate profilele de aluminiu sunt complet încastrate în perete, maximizând volumul de lumină naturală.
- / Acționare controlată prin telecomandă, pentru un acces facil.
- / Siguranța maximizată printr-un sistem central de control (senzori de mișcare, blocare electromagnetică și detectarea focului), compatibil cu aplicațiile pentru casele inteligente.
- / Profil de by-pass îngust, cu suprafața vizibilă de aluminiu de doar 25 mm.
- / Manevrarea este posibilă și în cazul unei eventuale pene de curent, multumită bateriilor reîncărcabile incluse.
- / Poate fi manevrat manual, în caz de urgență.
- / Profile ascunse pentru drenarea apei.

Caracteristici tehnice

	Profil ascuns
Suprafața de aluminiu vizibilă	
Înălțime toc	45 mm
Latime toc	174 mm
Înălțime cercevea	25/32 mm
Latime cercevea	67,4 mm
Latime profilului de by-pass	25 mm
Greutate cercevea	Pana la 700 Kg
Vitrare	52 mm
Izolare	Poliamida, PVC

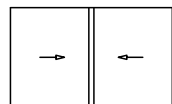

4 cercevele / 2 cai de rulare
4 sashes / 2 track

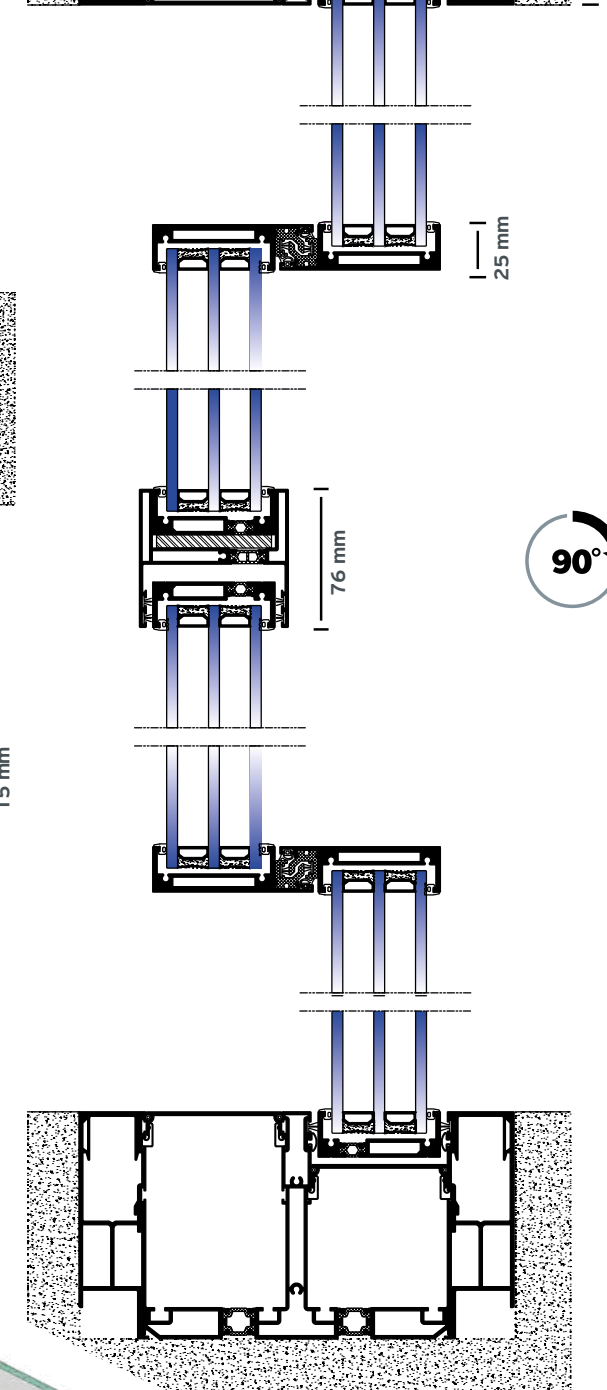
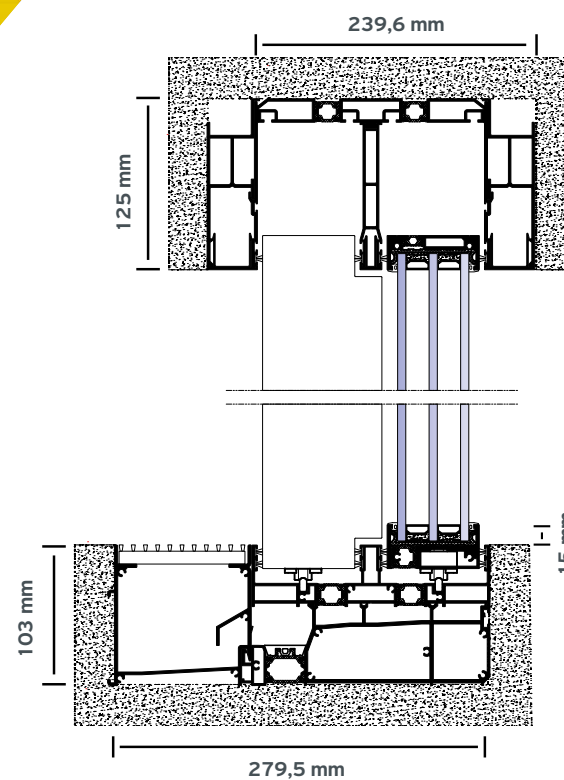
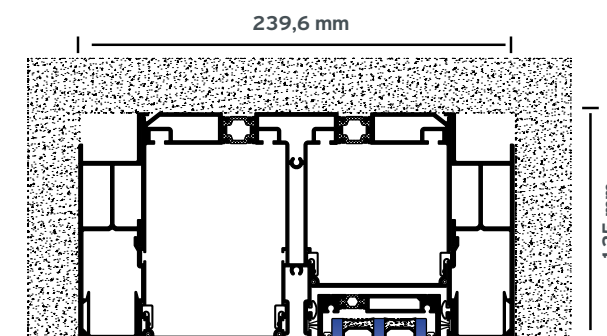
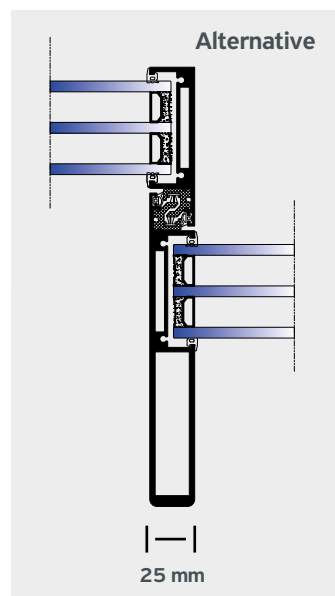
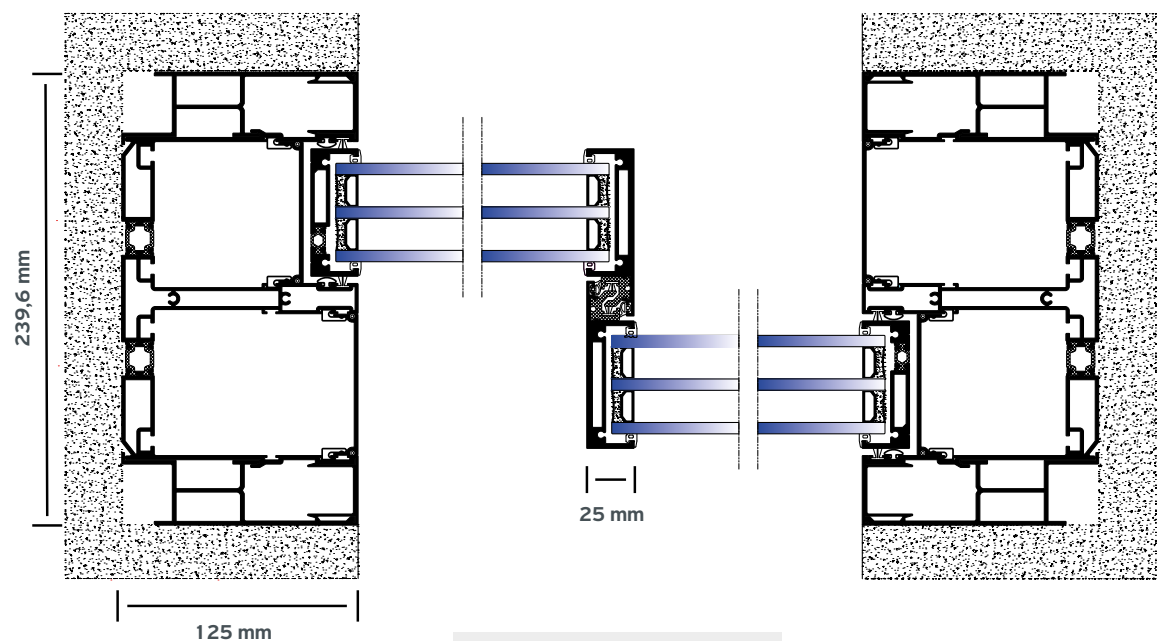
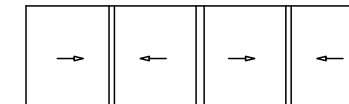

2 sashes / 2 track
2 cercevele / 2 cai de rulare

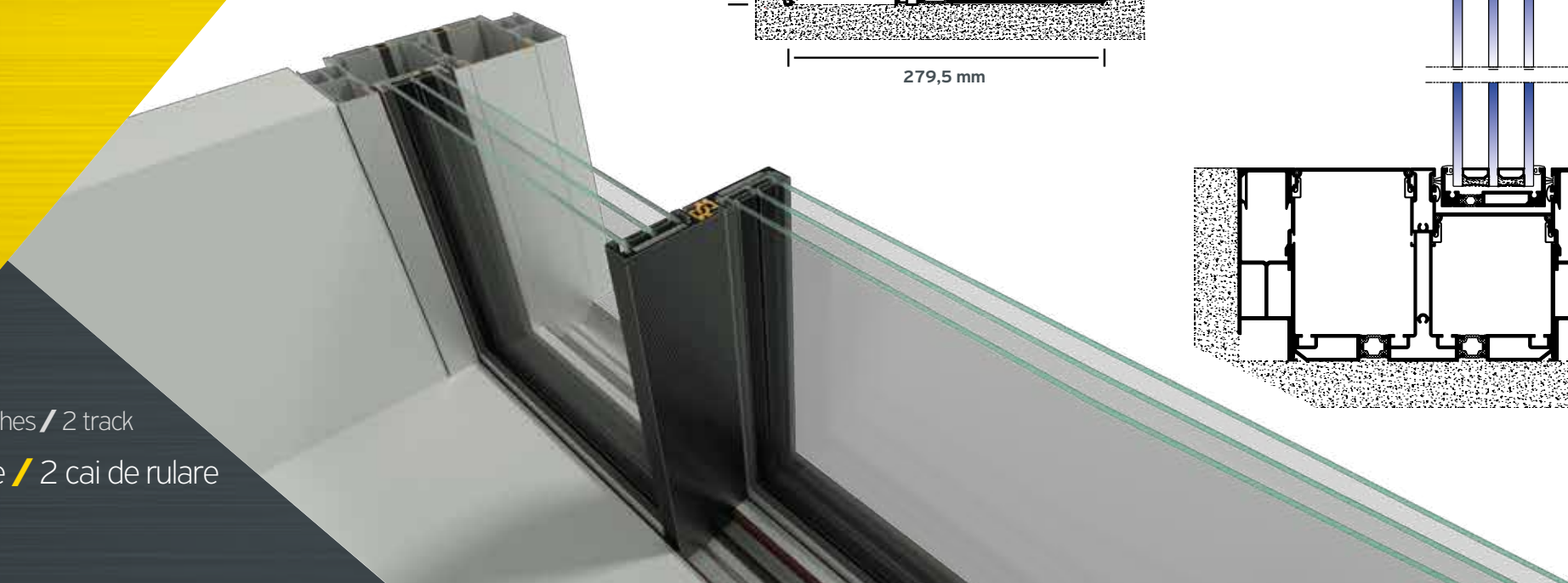

Colt exterior
External Corner

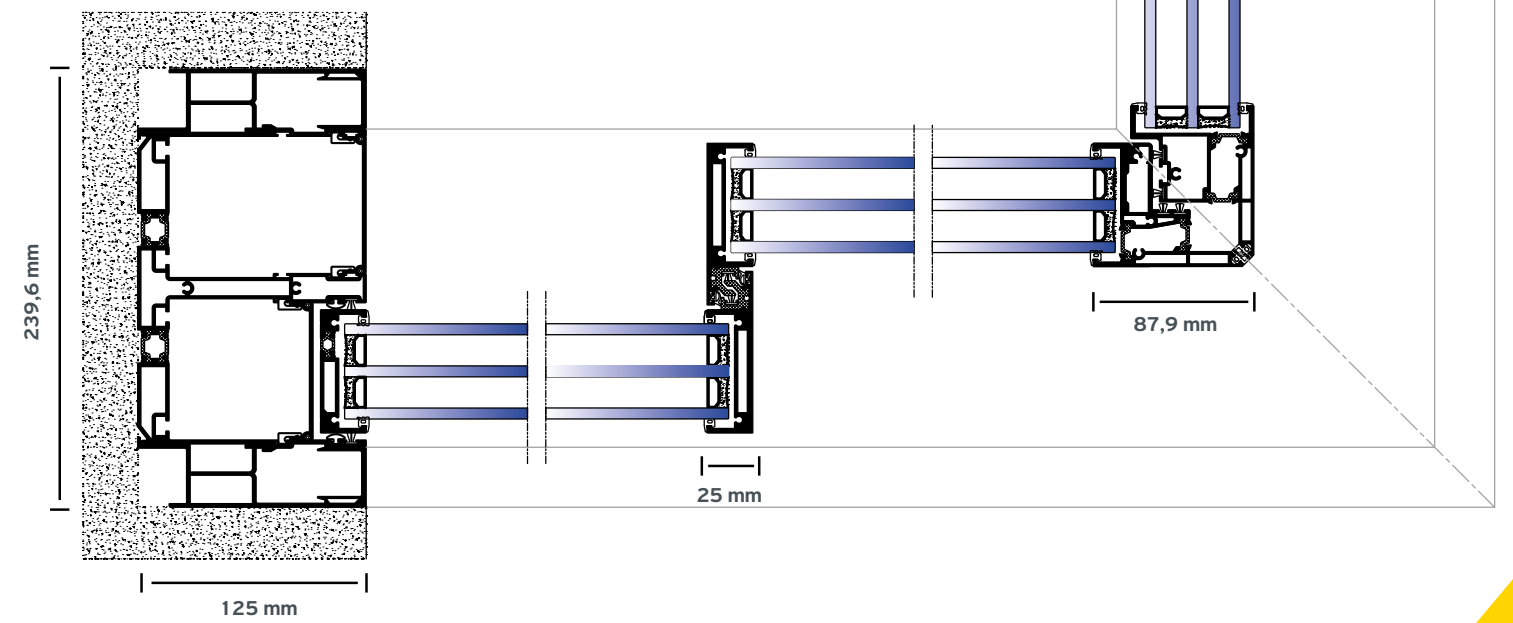
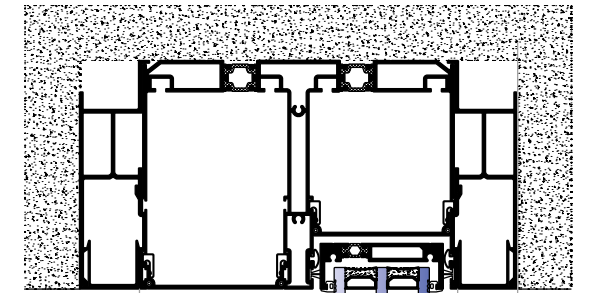
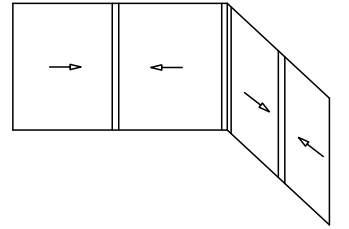

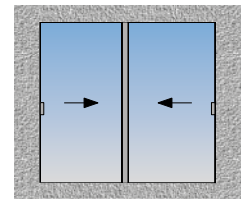

2 sashes / 2 track
2 canate / 2 cai de rulare

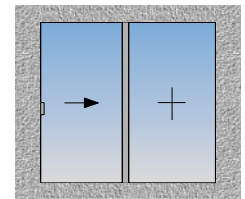

1 sash / Fixed
1 canat / Panou fix

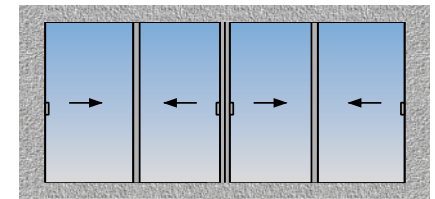

4 sashes / 2 track
4 canate / 2 cai de rulare

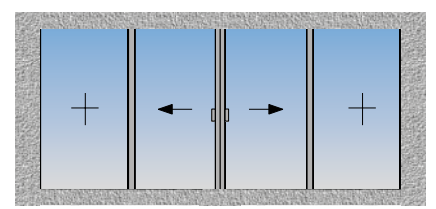

Fixed / 2 sashes / Fixed
Panou fix / 2 canate / Panou fix

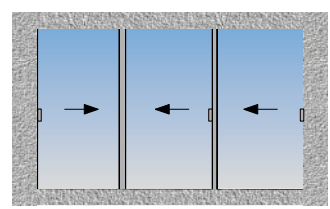

3 sashes / 3 track
3 canate / 3 cai de rulare

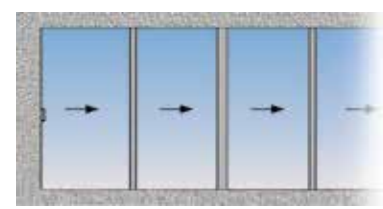

Multi track
Multi track

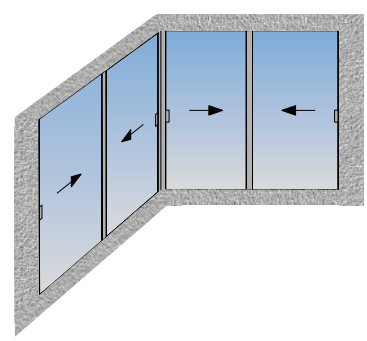

Internal / External corner
for all typologies
Colt interior / Exterior
pentru toate tipologiile

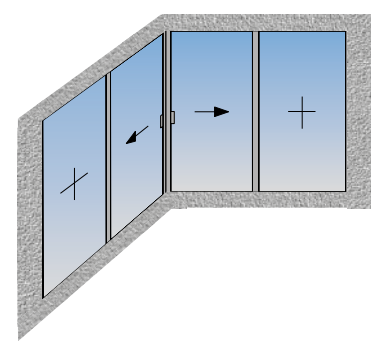

Internal / External corner
in combination with fixed lights
Colt interior / Exterior
in combinatie cu laterale fixe

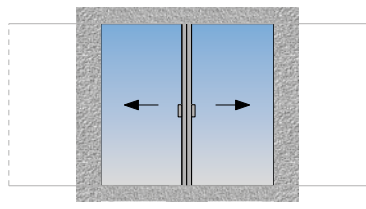

2 sashes / 1 track
2 canate / 1 cale de rulare

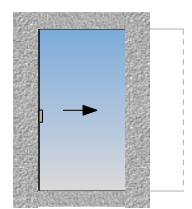

1 sash / 1 track
1 cercevea / 1 cale de rulare

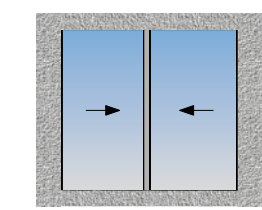

2 sashes / 2 track
2 canate / 2 cai de rulare

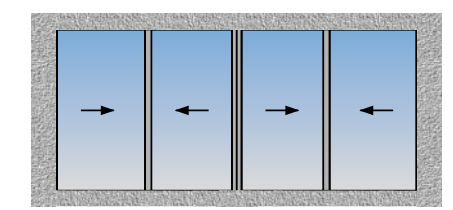

4 sashes / 2 track
4 canate / 2 cai de rulare

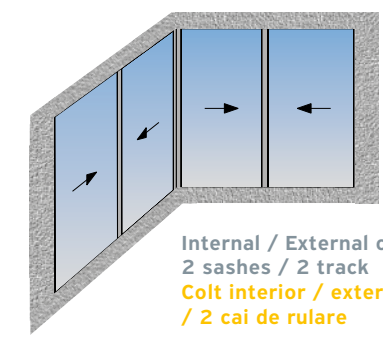

Internal / External corner
2 sashes / 2 track
Colt interior / exterior 2 canate
/ 2 cai de rulare

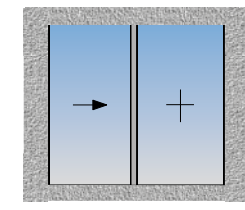

1 sash / Fixed
1 cercevea / panou fix

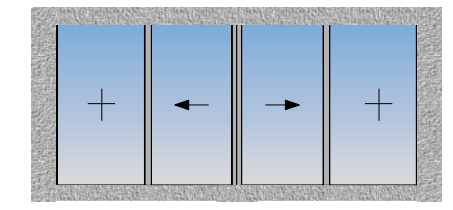

Fixed / 2 sashes / Fixed
Panou fix / 2 canate / panou fix

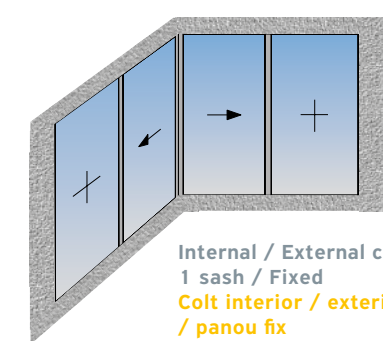





Internal / External corner
1 sash / Fixed
Colt interior / exterior 1 cercevea
/ panou fix



Performance Performante

CERTIFICATION CERTIFICARE

	Water tightness EN 12208
	Air permeability EN 12207
	Wind load resistance, max. test pressure EN 12210
	Wind load resistance to frontal deflection EN 12210
	Burglar Resistance EN 1627 -1630

CLASSIFICATION CLASIFICARE

1A	2A	3A	4A	5A	6A	7A	8A	* 9A	** E1050
(0 Pa)	(50 Pa)	(100 Pa)	(150 Pa)	(200 Pa)	(250 Pa)	(300 Pa)	(450 Pa)	(600 Pa)	(1050 Pa)
1			2			** 3			* 4
1 (400 Pa)		* 2 (800 Pa)		** 3 (1200 Pa)			4 (1600 Pa)		5 (2000 Pa)
A (≤ 1/150)				B (≤ 1/200)					C (≤ 1/300)
RC 1				RC 2					RC 3

* performances for S650 PHOS ** performances for S650 e-MOTION * performante pentru S650 PHOS ** performante pentru S650 e-MOTION

ALUMIL has also certified the system SUPREME S650 according to AAMA & AS standards which are available upon request
ALUMIL a certificat sistemul SUPREME S650 si conformitate cu standardele AAMA & AS, ce sunt disponibile la cerere

THERMAL PERFORMANCE PERFORMANTA TERMICA	Dimensions in mm (W x H)	U _w in W/m ² K (U _g = 0,6)	U _w in W/m ² K (U _g = 0,8)	U _w in W/m ² K (U _g = 1,1)
2 sashes / 2-track	2600 x 2400	1,14	1,32	1,59
2 sashes / 2-track Low threshold	2600 x 2400	1,15	1,32	1,59
4 sashes / 2-track	5200 x 2400	1,12	1,30	1,57

Thermal performance for non-installed frames certified according to EN ISO 10077-2
Performanta termica pentru tamplarie neinstalata certificata in conformitate cu EN ISO 10077

THERMAL PERFORMANCE PERFORMANTA TERMICA	Dimensions in mm (W x H)	U _w in W/m ² K (U _g = 0,6)	U _w in W/m ² K (U _g = 0,8)	U _w in W/m ² K (U _g = 1,1)
2 sashes / 2-track	2600 x 2400	0,83	1,03	1,33
2 sashes / 2-track Low threshold	2600 x 2400	0,83	1,03	1,33
4 sashes / 2-track	5200 x 2400	0,89	1,08	1,37

Thermal performance for installed frames (frame profiles concealed into the floor, the ceiling and the walls)
Performanta termica pentru tamplarie instalata (toc ascuns in pardoseala, tavan si in perete)



Private residence
in Lagos,
Nigeria



Reference Projects Proiecte de referinta

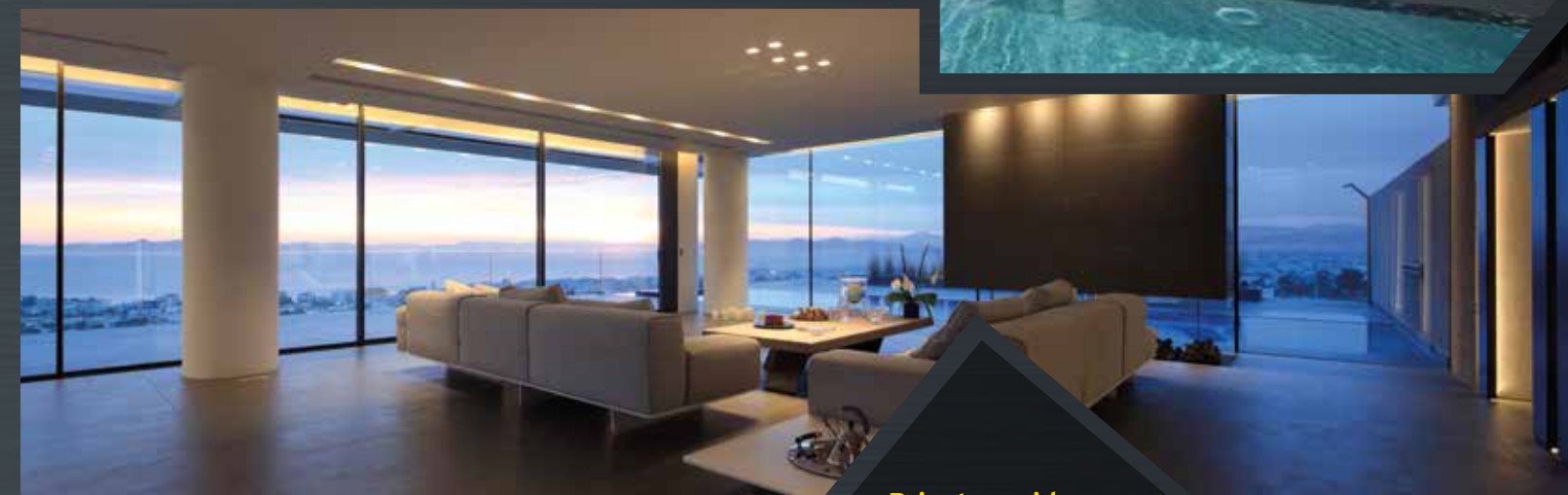

Private residence
in Athens
Greece
ISV ARCHITECTS



ALUMIL ROMANIA - OFFICES & SHOWROOM

Sos. Bucuresti-Ploiesti, nr.42-44,
Baneasa Business & Technology Park,
Cladirea A, Aripa A1, parter, Sector 1
Tel.: +40 21 4243456 - 8
Fax: +40 214233932
www.alumil.ro
E-mail: office@alumil.ro - showroom@alumil.ro

**HEAD OFFICES
& SHOWROOM - THESSALONIKI**

Gogousi 8, Efkarpia
Thessaloniki - GR 564 29
Tel.: +30 2313 01 1000
Fax: +30 2310 692473
E-mail: info@alumil.com

**HEADQUARTERS & FACTORY
KILKIS INDUSTRIAL AREA**

Kilkis - GR 611 00
Tel.: +30 23410 79300
Fax: +30 23410 71988
E-mail: info@alumil.com

alumil

www.alumil.com