



Alumil

Alumil  **SUPREME**
SF85



Unique folding doors with impressive minimal design,
thermal insulation and performance

Usi armonice cu design minimalist,
bariera termica si performanta de top

SUPREME SF85 is an exceptional folding door system with minimal design and extraordinary narrow sight lines. At the same time, the series offers outstanding performance and the ability to create very large constructions.

SUPREME SF85 este o solutie de top pentru usi armonice, cu design minimalist si linii inguste. In acelasi timp, sistemul ofera performanta exceptionala si posibilitatea de a realiza constructii foarte mari.

DESIGN PHILOSOPHY & CHARACTERISTICS FILOSOFIA DESIGN-ULUI & CARACTERISTICI	4
UNPARALLELED ADVANTAGES BENEFICII INEGALABILE	6
SPECIAL FEATURES & FITTINGS CARACTERISTICI SPECIALE SI ACCESORII	10
SECTIONS SECTIUNI	14
APPLICATIONS APLICATII	24
PERFORMANCE PERFORMANTE	26

Design philosophy & characteristics

Filosofia design-ului & caracteristici



- / Extremely reduced sight lines and excellent minimal design.
- / Very large dimensions in terms of height (up to 4,0 m), vent width (exceeding 1,5 m) and total construction width.
- / Extremely high thermal insulation for maximum energy savings.
- / Outstanding performance in terms of water tightness, air permeability and wind load resistance.
- / Enhanced safety and burglar protection due to quadruple locking latches and anti-lift mechanism.
- / Ultra-smooth and long-lasting operation.

Technical characteristics

Sash width	85 mm
Sash to sash sight line	105 mm
Glazing	21-58 mm
Thermal insulation	Polyamides 40 mm width, Kooltherm insulation & PE insulation foam
Main gasket	Co-extruded foam EPDM
Panel locking	Quadruple latches
Vent weight	Up to 200 Kg/vent

- / Linii inguste si design minimalist excelent.
- / Poate fi realizat in dimensiuni mari, in ceea ce priveste inaltimea (pana la 4,0 m), latimea deschiderii (peste 1,5 m).
- / Nivel foarte ridicat al izolarii termice, pentru reduceri de cost privind energia.
- / Performante remarcabile in ceea ce priveste etanseitatea la apa, permeabilitatea aerului si rezistenta la incarcarile generate de vant.
- / Siguranta sporita si protectie anti-efractie imbunatatite, multumita sistemului de blocare in 4 puncte si mecanismului anti-lift.
- / Operare ultra-lina si de durata.

Impressive energy efficiency and security, combined with timeless aesthetics and remarkably oversized constructions

Siguranta si eficienta energetica remarcabile, combinate cu estetica atemporală si constructii de dimensiuni impresionante

SUPREME SF85 is ideal for flawless high-end residential and commercial applications, as well as for heavy-duty constructions. Its flexibility and the variety of typologies (e.g. even & odd number of vents, corner typologies and semi-structural version), provide numerous construction solutions, meeting every need in a very effective and elegant way.

SUPREME SF85 este ideal pentru aplicatii comerciale si rezidentiale fara cusur, precum si pentru constructii de dimensiuni ample. Flexibilitatea sa si varietatea mare de tipologii (ca de exemplu numarul par si impar de deschideri, tipologii de constructii cu colt liber sau versiuni semi-structurale), ofera nenumarate solutii pentru constructii, satisfacand fiecare nevoie intr-un mod eficient si elegant.

Caracteristici tehnice

Latime cercevea	85 mm
Latimea in zona intermediara	105 mm
Grosimea geamului termoizolant	21-58 mm
Izolare termica	Poliamida cu latimea de 40 mm, Kooltherm si spuma izolatoare PE
Garnitura centrala	Spuma EPDM coextrudata
Sistemul de inchidere	Incuietoare cvadrupla
Greutatea deschiderii	De pana la 200 Kg/deschidere

Total comfort & sense of freedom

Confort total & simtul libertatii



Incomparable Aesthetics

Minimal design with amazingly reduced sight lines and less aluminium, since the system allows constructions of much wider vents and consequently fewer vents are needed to cover large spans (e.g. five vents instead of seven).

- / Sash to sash sight line: 105 mm.
- / Frame to sash sight line: 110 mm.
- / Vent width can exceed 1,5 m.

The available semi-structural version can upgrade the aesthetic value of the building even further.

Estetica inegalabila

Design minimalist cu linii fine de aluminiu, avand in vedere faptul ca sistemul permite realizarea de constructii cu deschideri mult mai ample si, prin urmare, sunt necesare mai putine deschideri pentru a acoperi spatiile mari (de exemplu, 5 deschideri in loc de 7).

- / Latimea in zona intermediara: 105 mm.
- / Latimea ansamblului toc-cercevea: 110 mm.
- / Latimea deschideiri poate depasi 1,5 m.

Versiunea semi-structurala disponibila poate imbunatati valoarea estetica a constructiei chiar si mai mult.

Extremely large dimensions

The system achieves very large dimensions in terms of:

- / Height: up to 4,0 m.
- / Vent width: up to 1,5 m.
- / Total width: possibility for large number of vents and very wide spans.

Ideal for modern residences especially when wider vents are required (e.g. 3 vents of 1,5 m width each, instead of 5 vents of 0,90 m width).

Ideal for commercial projects with structures of 4,0 m height and with a large number of vents.

Dimensiuni extrem de mari

Sistemul ofera dimensiuni foarte ample in termeni de:

- / Inaltime: pana la 4,0 m.
- / Latime deschidere: pana la 1,5 m.
- / Latime totala: posibilitatea realizarii mai multor deschideri si a spatiilor foarte ample.

Ideal pentru resedinte moderne, mai ales in situatiile in care sunt necesare deschideri mai largi (de exemplu 3 deschideri de 1,5 m latime fiecare, in loc de 5 deschideri de 0,90 m latime).

Este un sistem ideal pentru proiecte cu structuri de 4,0 m inaltime si cu un numar mai mare de deschideri.

Variety and flexibility

Vast variety of folding door solutions thanks to the numerous typologies and the flexible design of the system.

- / Odd number of vents (e.g. 3+0, 7+1, 5+3).
- / Even number of vents (e.g. 4+0, 2+1, 4+3).
- / Corner constructions.
- / Semi-structural version.
- / Inwards or outwards opening.
- / Standard or low threshold.

Varietate si flexibilitate

Varietate mare de solutii pentru usi armonice, multumita tipologiilor numeroase si a design-ului flexibil al sistemului.

- / Numar impar de deschideri (de exemplu 3+0, 7+1, 5+3).
- / Numar par de deschideri (de exemplu 4+0, 2+1, 4+3).
- / Constructii cu colt liber.
- / Versiune semi-structurala.
- / Deschidere interioara sau exteriora.
- / Prag standard sau cu dimensiuni reduse.



Luxury
HOTEL

Extremely high thermal efficiency

High energy savings with U_w values around $1.0 \text{ W/m}^2\text{K}$, thanks to co-extruded EPDM foam gasket, Kooltherm core, 40 mm width polyamides, PE insulation foam and overall sophisticated design.

Nivel foarte ridicat de eficienta termica

Reducere de pierderi de energie cu valori U_w in jur de $1.0 \text{ W/m}^2\text{K}$, multumita garniturii co-extrudate din spuma EPDM, zona centrala Kooltherm, poliamida cu latimea de 40 mm, spuma izolatoare PE si un design sofisticat, per ansamblu.

Top level of security

Enhanced burglar protection levels, which meet all industry security standards thanks to:

- / Quadruple locking latches from glass reinforced polyamide (instead double).
- / Bottom roller-hinge with anti-lift mechanism.
- / Profile and hinges sturdiness.
- / 5-point lock.
- / Possibility for very thick glazing (21-58 mm).

Nivel foarte ridicat al sigurantei

Protectie anti-efractie imbunatatita, pentru a indeplini toate standardele de siguranta ale industriei, multumita:

- / Incuietorilor cvadruple, cu poliamida ranforsata din sticla (in loc de dubla).
- / Balama inferioara rulanta cu mecanism anti-lift.
- / Nivel ridicat de rezistenta a profilului si a balamalelor.
- / 5 puncte de blocare.
- / Posibilitatea montarii unei sticle de grosime mare (21-58 mm).

Reliability

Smooth, long-lasting and flawless operation due to the special top and bottom roller-hinges, the heavy-duty hinges and the overall quality of the system.

Incredere

Operare lina, de durata si fara cusur, multumita cailor inferioare si superioare de rulare, balamalelor rezistente si a calitatii intregului sistem.

Outstanding performance

- / Air permeability: class 4.
- / Wind load resistance: class C3/B3.
- / Water tightness: class 8A.

Certified by the IFT Rosenheim Institute.

Performanta de top

- / Permeabilitatea aerului: Clasa 4.
- / Rezistenta la incarcarile generate de vant: Clasa C3/B3.
- / Etanseitatea la apa: clasa 8A.

Sistemul este certificat de Institutul IFT Rosenheim.



Attention to detail Atentie la detalii

State-of-the-art fittings specially designed to achieve unparalleled performance and smooth bottom-slide operation.

Accesorii de ultima generatie, proiectate special pentru a obtine performante inegalabile si o operare lina.

Special bottom roller-hinge

- / Max weight up to 500 Kg.
- / Anodised body, stainless steel rollers and rust-protected bearings.
- / Allows very large dimensions.
- / Enables very easy installation and long-lasting flawless operation.
- / Anti-lift protection mechanism for enhanced burglar protection.

Cale de rulare inferioara speciala

- / Greutate maxima de pana la 500 Kg.
- / Sistem anodizat, role din otel inoxidabil si rulmenti tratati contra coroziunii.
- / Permite instalarea foarte facila si operarea de durata si fara cusur.
- / Mecanism de protectie anti-lift, pentru o protectie anti-efractie imbunatatita.
- / Permite obtinerea unor dimensiuni ample.

Special top roller-hinge

Though bottom-slide operation, the top roller-hinge, apart from guiding the vents:

- / contributes in lifting the vent thanks to a special spring mechanism.
- / is quite long to prevent the vents from rotating during operation.

Rola-balama superioara speciala

Desi glisarea se realizeaza la partea inferioara, rola-balama superioara, pe langa faptul ca ghideaza canatele:

- / Contribuie la ridicarea canatelor multumita unui sistem special pe arcuri.
- / Este suficient de lunga pentru a preveni efectul de rasturnare a canatelor in timpul deschiderii.

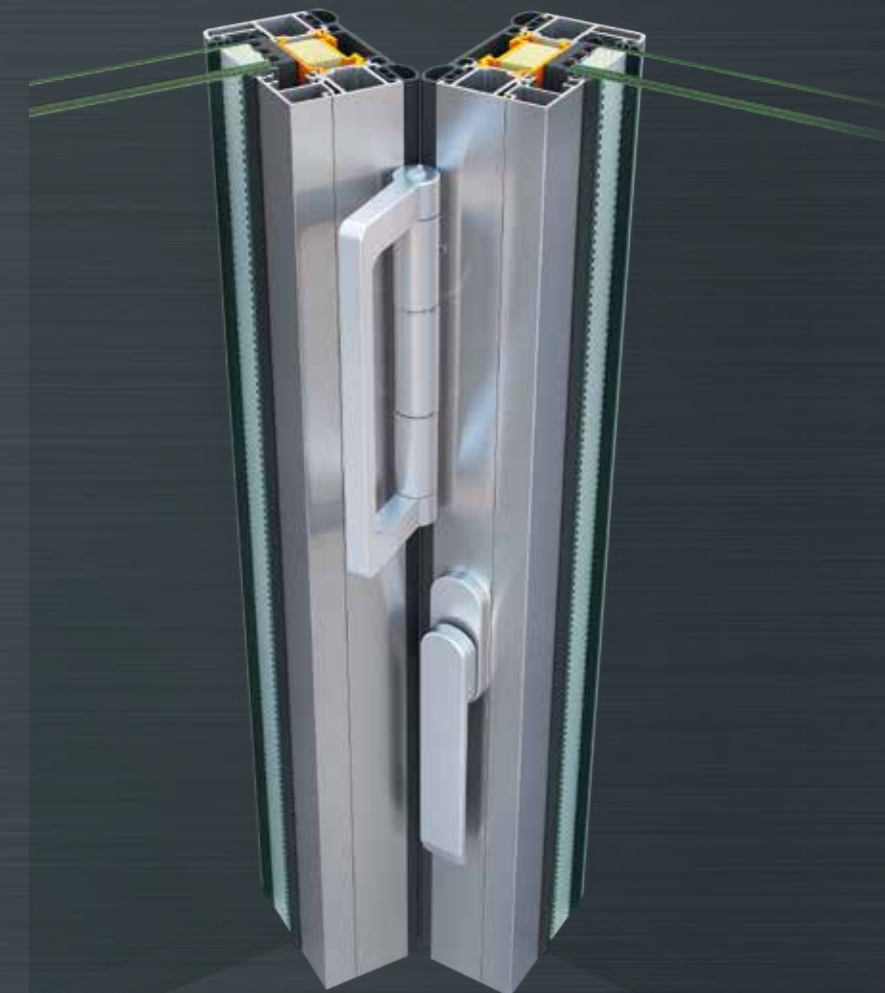
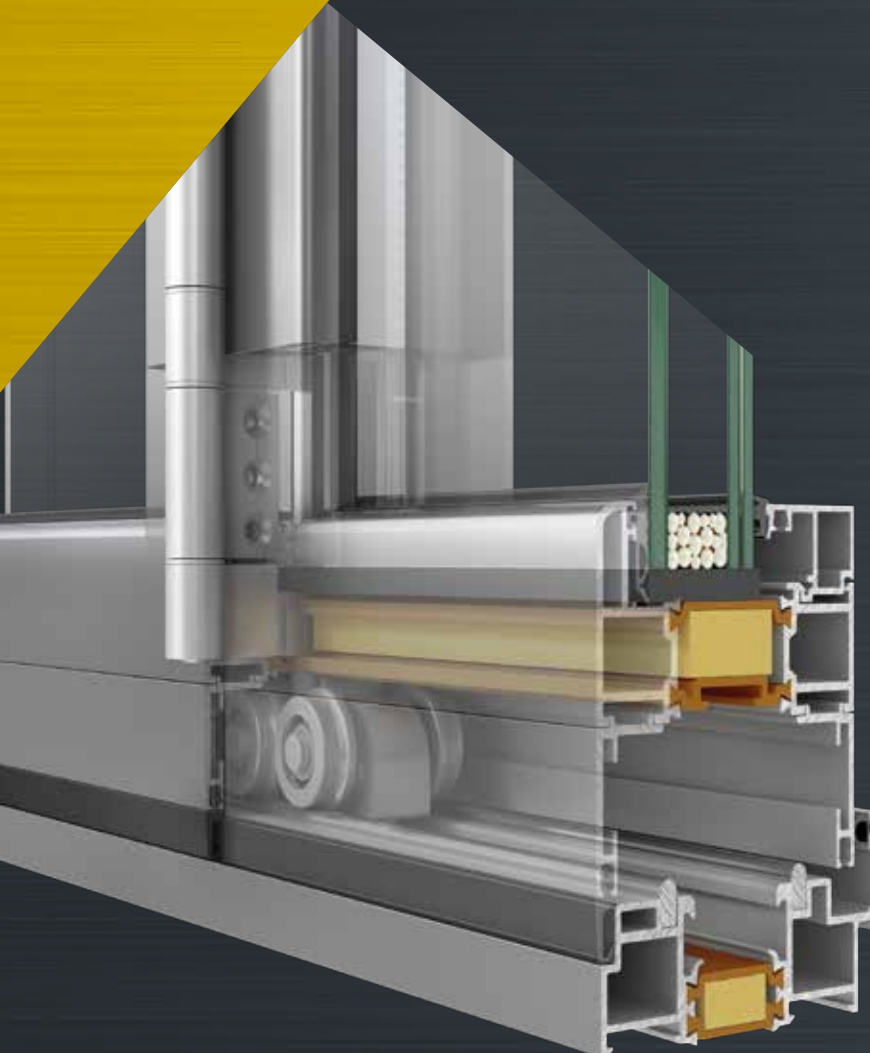
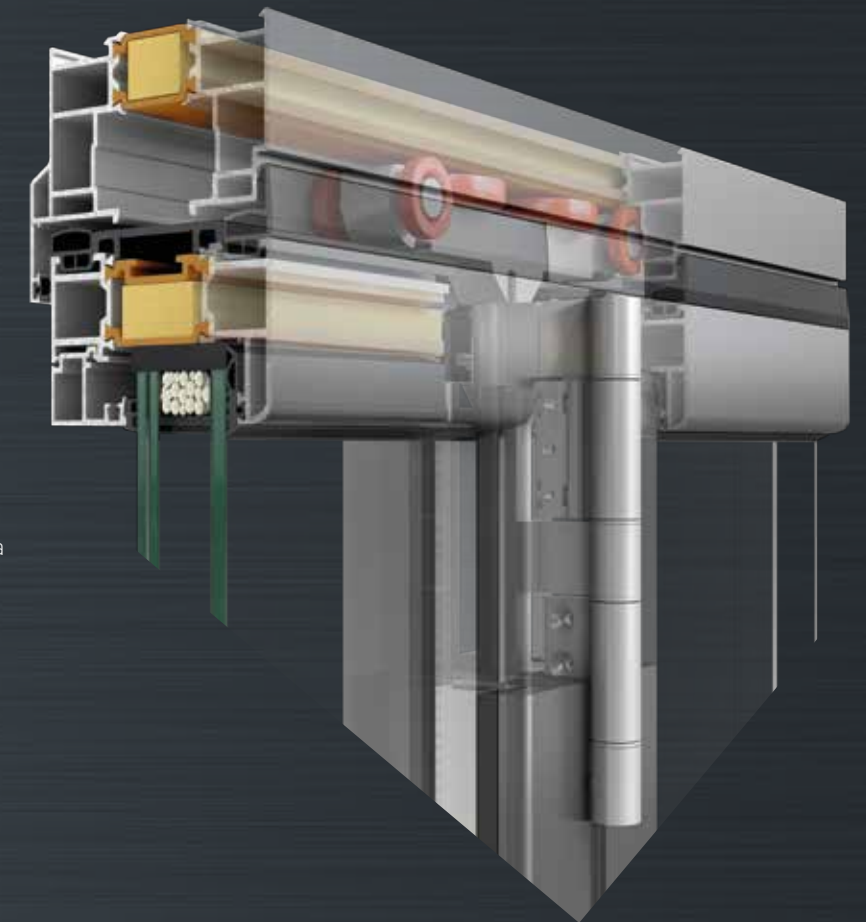

Fittings for easy handling

- / Extremely efficient heavy-duty hinges: three (3) hinges are in most times adequate for each pair of vents.
- / Pull-handle attached on the intermediate hinge.
- / Special ALUMIL design handle for the intermediate vents.
- / ALUMIL design door handle.

Accesorii pentru o manevrare usoara

- / Balamale foarte eficiente: 3 balamale sunt cel mai adesea potrivite pentru fiecare pereche de canate.
- / Maner anexat pe fiecare balama intermediata.
- / Manere special proiectate de ALUMIL pentru deschiderile intermediare.
- / Maner ALUMIL.

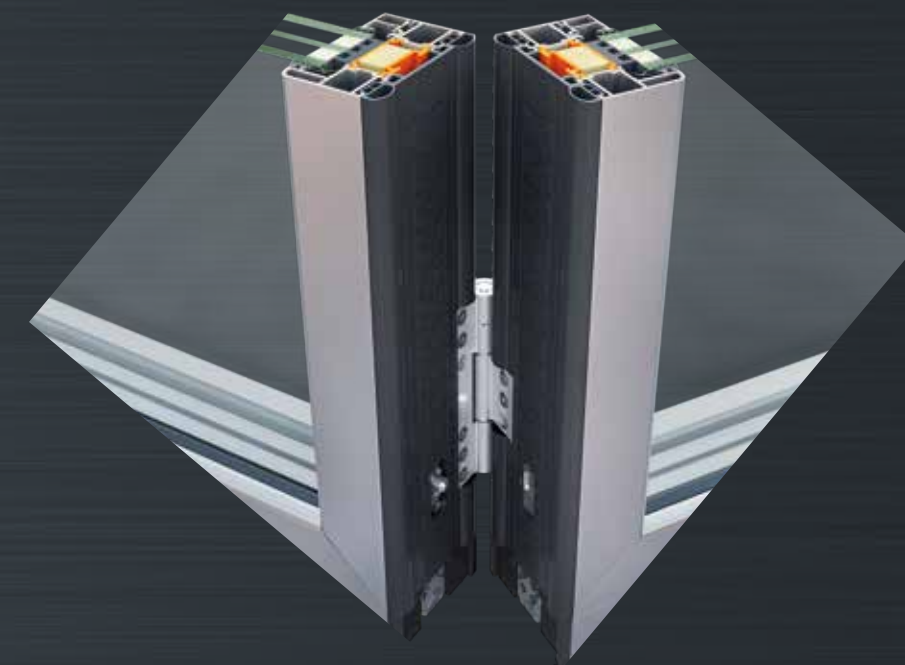

- / Intermediate vents locking with special quadruple latches made of glass reinforced polyamide.
- / Single co-extruded gasket made of EPDM and foam.
- / Double set of glass reinforced polyamides 40 mm.
- / Kooltherm and PE insulation foam for enhanced thermal insulation.

- / Puncte intermediare de blocare a deschiderilor cu incuietori cvadruple speciale, din poliamida ranforsata cu fibra de sticla.
- / Garnitura unica, co-extrudata, din EPDM si spuma.
- / Set dublu de poliamida de 40 mm ranforsata cu fibra de sticla.
- / Izolare termica imbunatatita cu spuma izolatoare PE si Kooltherm.



- / Special fittings for the easy adjustment of the double frame profile.
- / Option between solid or hollow inox guide rails.
- / Enhanced sealing around the hinge thanks to special rubber fittings.
- / Special cap for the milled part of the guide.
- / Rubber fitting to cover the guide rail beneath the hinged door.

- / Accesorii speciale pentru ajustarea facila a profilului de toc compus.
- / Posibilitatea de a alege cale de rulare din inox plina sau de forma U.
- / Etansare suplimentara in zona balamalelor, multumita accesoriilor de cauciuc.
- / Capac special pentru partea frezata a caii de rulare.
- / Accesorii de cauciuc pentru a acoperi calea de rulare sub usa batanta.



- / Standard version with glazing beads for various glass thicknesses.
- / Semi-structural version for a unique result.
- / Option between standard or low threshold.

- / Versiune standard cu baghete pentru diferite grosimi ale pachetului de sticla.
- / Versiune semi-structurata pentru un efect unic.
- / Optiune pentru prag standard sau cu dimensiuni reduce.



3 deschideri
pe o directie
3 vents
one side

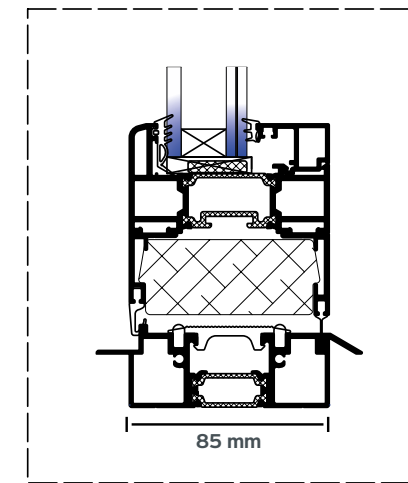
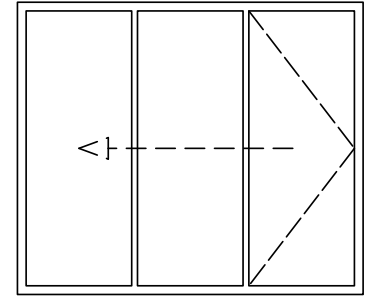

low threshold

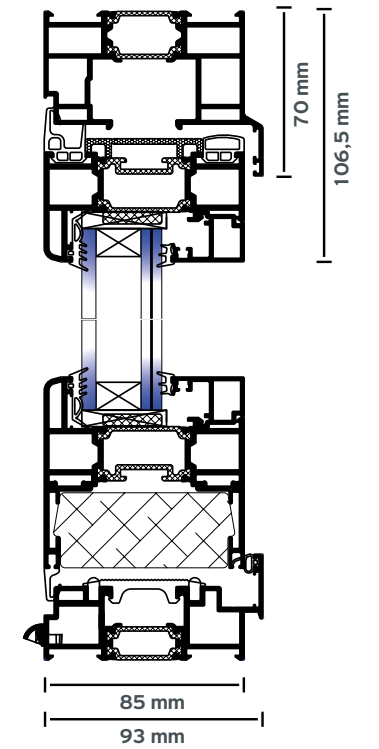

standard threshold

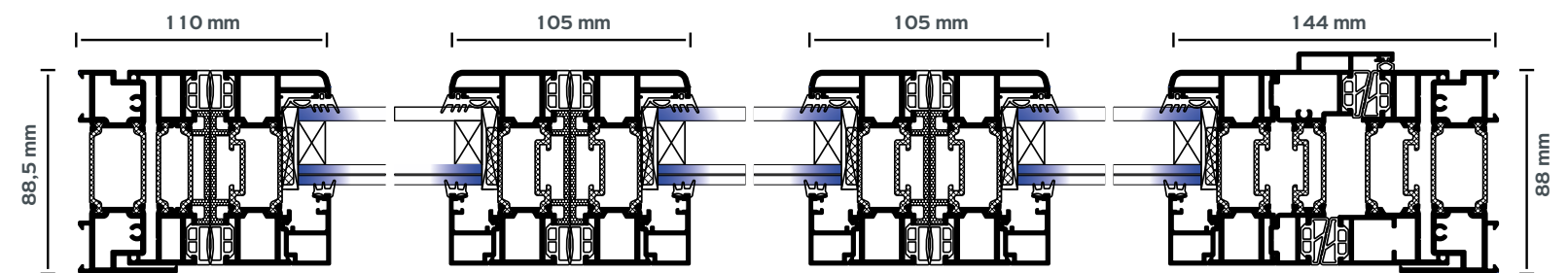

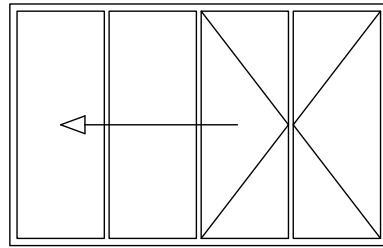

3+3 deschideri
inchidere cap in cap
3+3 vents
meeting stile

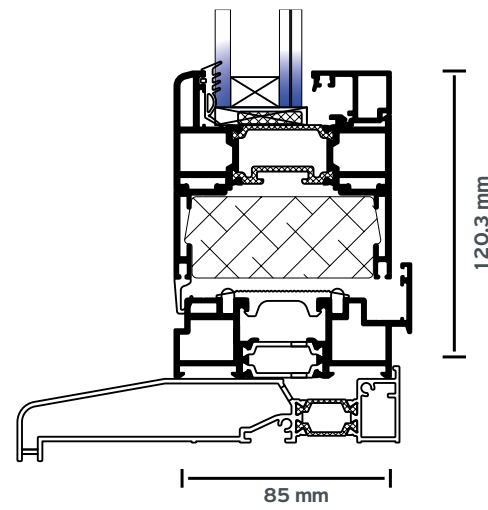
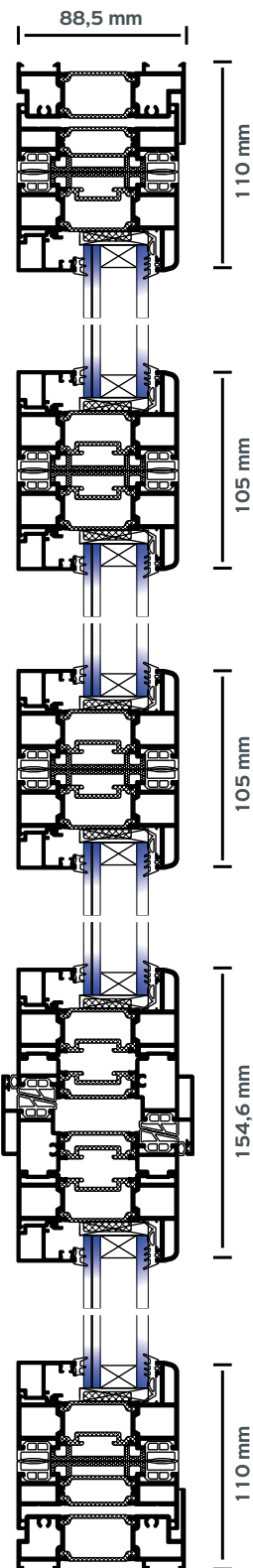
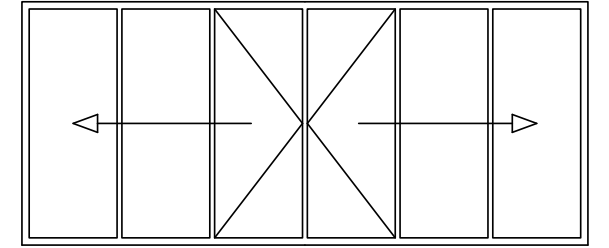

Insulated window sill integration
Integrarea pervazului ferestrei izolate termic

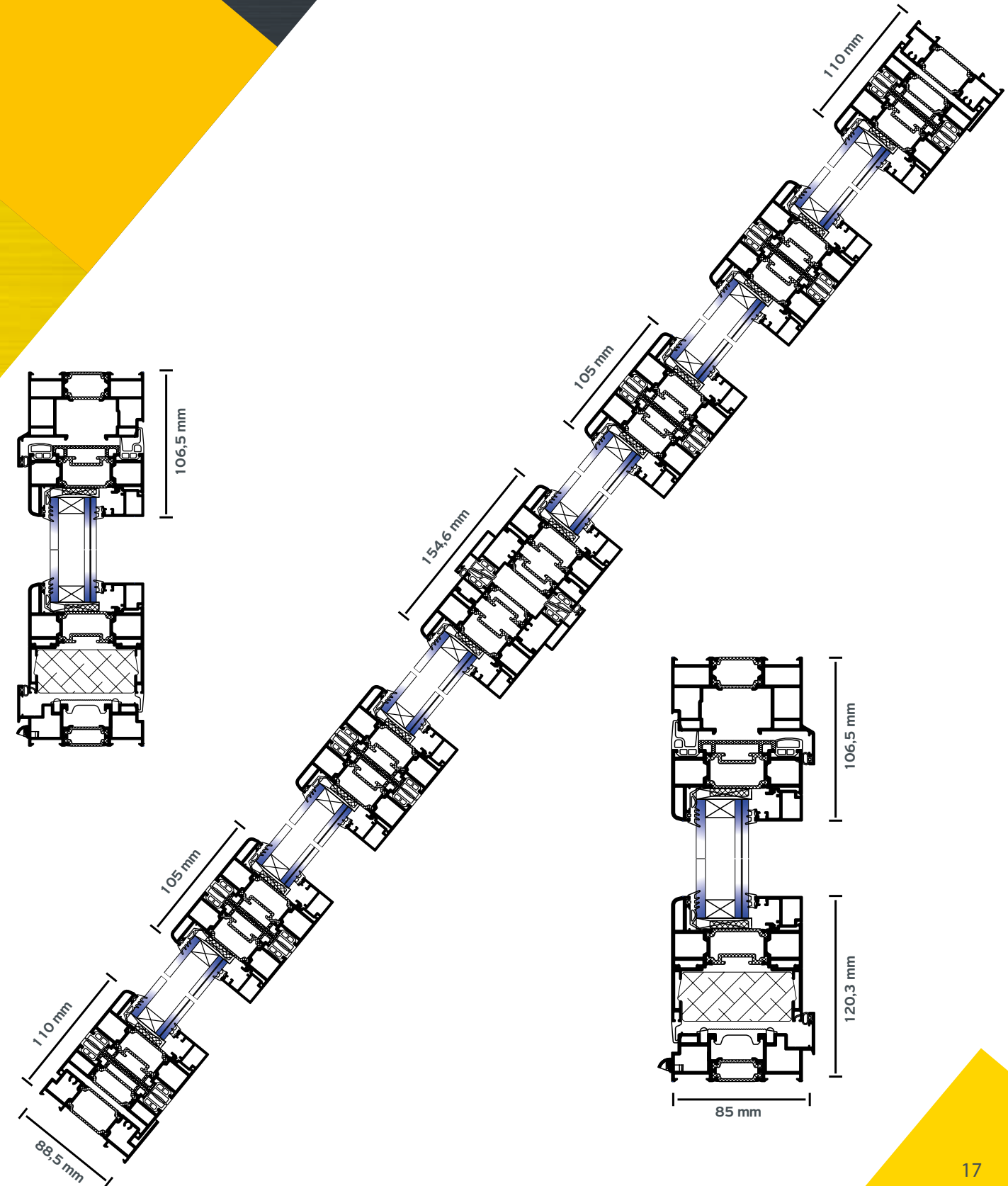

3+1 vents
door panel
3+1 deschideri
panel usa

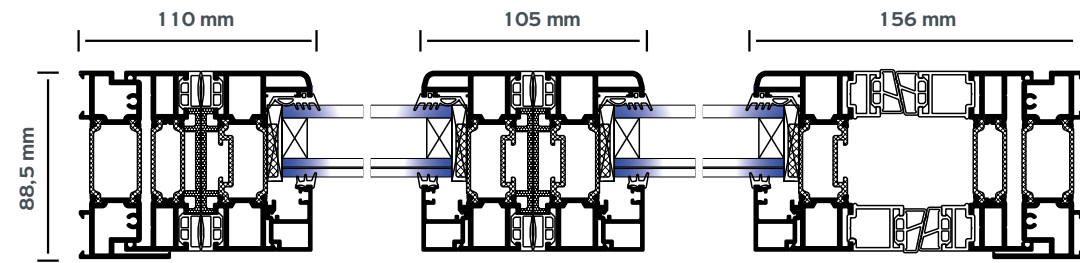
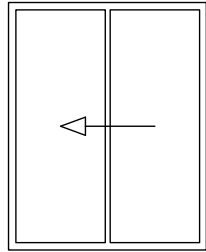

3+2 deschideri
inchidere cap in cap
3+2 vents
meeting stile

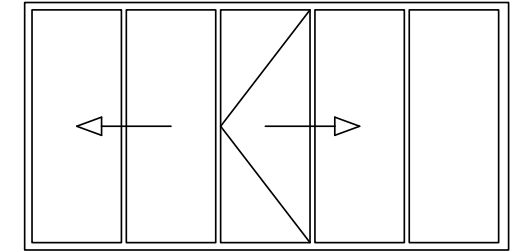

2 vents
one side
2 deschideri
o directie



3+3 constructie cu colt liber
3+3 corner construction

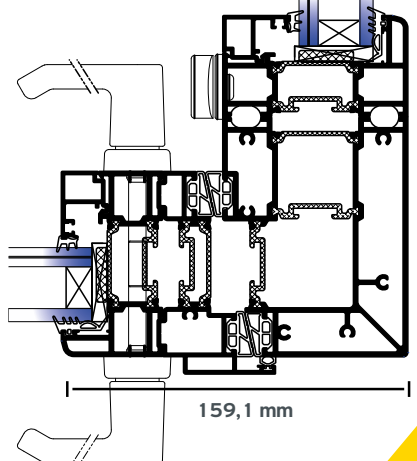
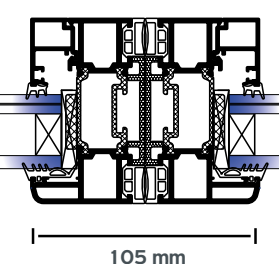
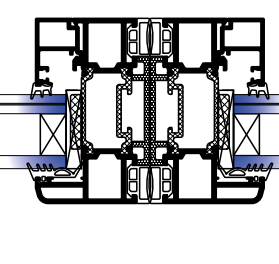
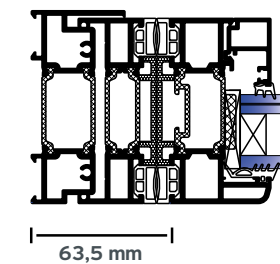
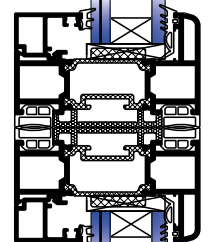
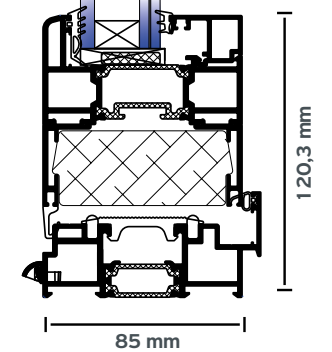
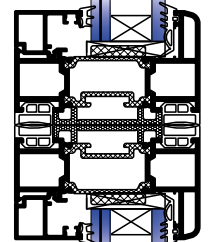
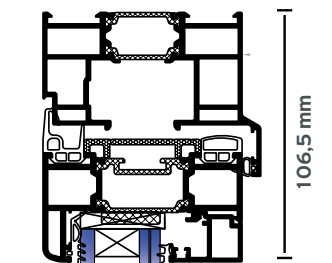
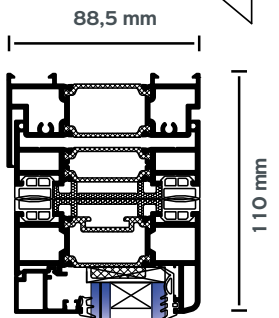
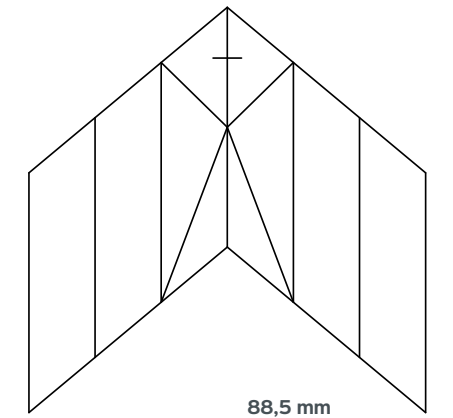

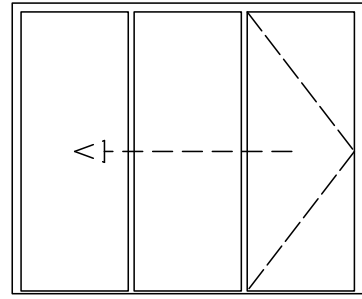

3+1 semi-structural
3+1 semi-structural

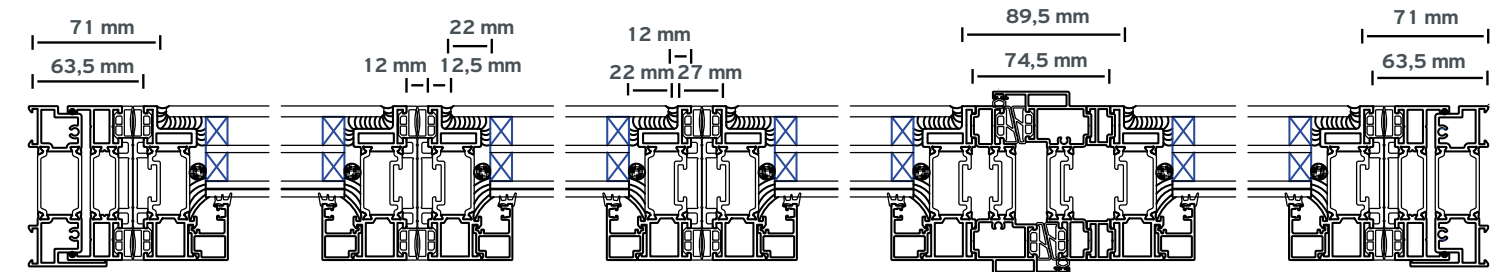
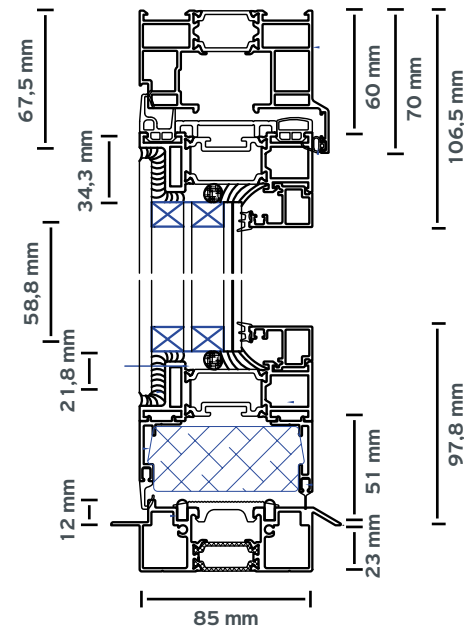
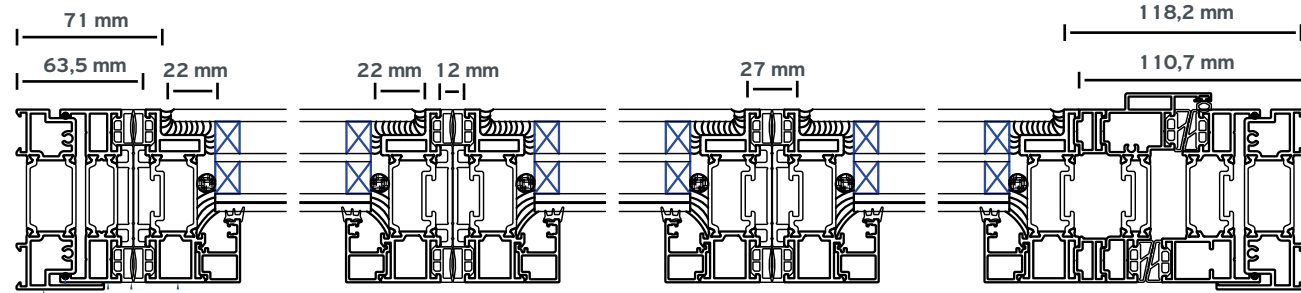
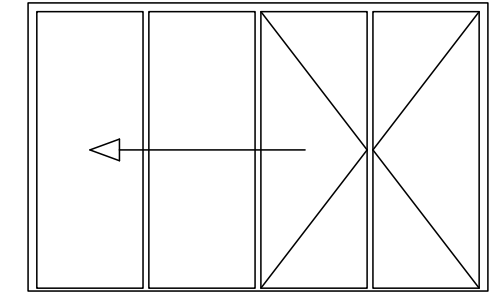

3 semi-structural
3 semi-structural

Applications Aplicatii

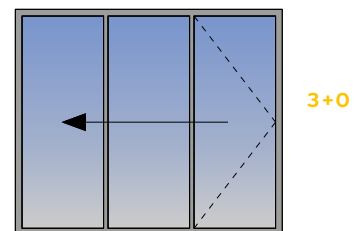

3+0

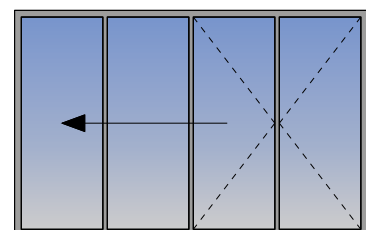
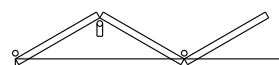

3+1

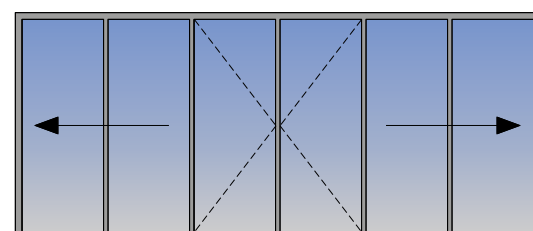
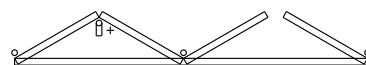

3+3

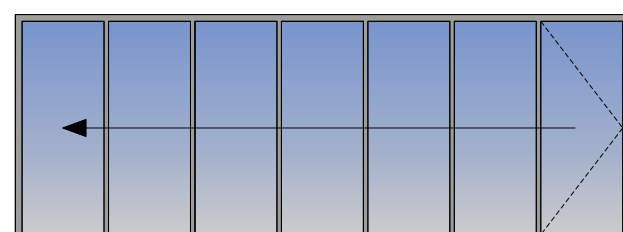

7+0

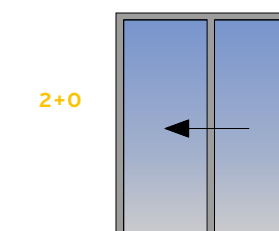
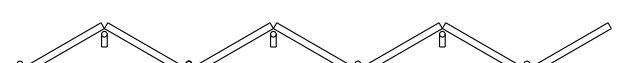

2+0

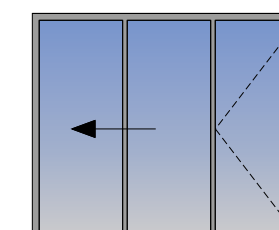

2+1

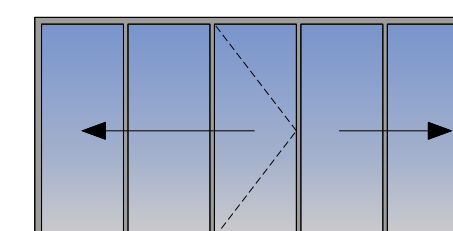

2+3

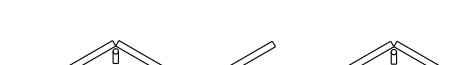

All typologies are compatible with:
 / standard (glazing bead) and semi-structural sash
 / standard and low threshold (embedded)
 / straight and corner structures
 / outward or inward opening

Toate tipologiile sunt compatibile cu:
 / cercevea standard si semi-structurata
 / prag standard sau cu dimensiuni reduse (incastrat)
 / structuri drepte de tipul colt liber
 / deschidere exterioara sau interioara

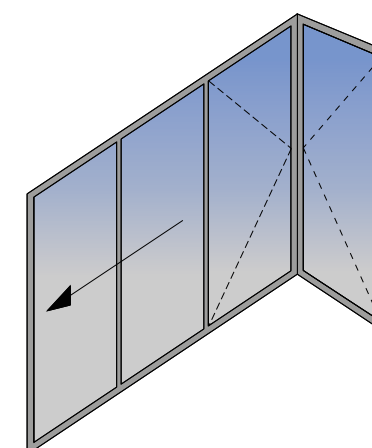



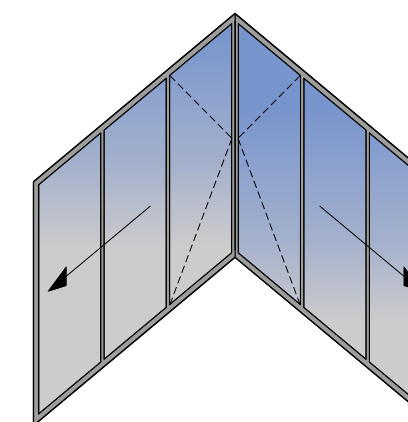

3+1 Corner construction
constructie cu colt liber



3+3 Corner construction
constructie cu colt liber

Performance Performante

CERTIFICATION CERTIFICARI

-  Water tightness
EN 12208:1999-11
-  Air permeability
EN 12207:2016-12
-  Wind load resistance
EN 12210:2016-03
-  Wind load resistance
EN 12210:2016-03
-  Burglar Resistance
EN 1627-1630
-  Burglar Resistance
PAS24 (UK)

CLASSIFICATION CLASIFICARE

1A (0 Pa)	2A (50 Pa)	3A (100 Pa)	4A (150 Pa)	5A (200 Pa)	6A (250 Pa)	7A (300 Pa)	8A (450 Pa)	9A (600 Pa)
1		2		3		4		4
1 (400 Pa)	2 (800 Pa)	3 (1200 Pa)		4 (1600 Pa)		5 (2000 Pa)		
A (≤ 1/150)		B (≤ 1/200)		C (≤ 1/300)				
RC 1		RC 2		RC 3				
Compliant								

THERMAL PERFORMANCE PERFORMANTA TERMICA

	Dimensions in mm (W x H) Dimensiuni in mm	U_w in W/m^2K ($U_g = 0.6$)	U_w in W/m^2K ($U_g = 0.8$)	U_w in W/m^2K ($U_g = 1.1$)
3+0	2600 x 3000	1,01	1,16	1,39
3+1	3450 x 3000	1,03	1,184	1,415



Corner construction
Construcție cu colț liber



Semi-structural sash
Cercevea semi-structurala



Even-odd number
of vents
Numar par sau
impar de deschideri



9-vent structure
Structura
cu 9 deschideri

ALUMIL ROMANIA - OFFICES & SHOWROOM

Sos. Bucuresti-Ploiesti, nr.42-44,
Baneasa Business & Technology Park,
Cladirea A, Aripa A1, parter, Sector 1
Tel.: +40 21 4243456 - 8
Fax: +40 214233932
www.alumil.ro
E-mail: office@alumil.ro - showroom@alumil.ro

**HEAD OFFICES
& SHOWROOM - THESSALONIKI**

Gogousi 8, Efkarpia
Thessaloniki - GR 564 29
Tel.: +30 2313 01 1000
Fax: +30 2310 692473
E-mail: info@alumil.com

**HEADQUARTERS & FACTORY
KILKIS INDUSTRIAL AREA**

Kilkis - GR 611 00
Tel.: +30 23410 79300
Fax: +30 23410 71988
E-mail: info@alumil.com

alumil

www.alumil.com