



**Alumil**  
Building excellence every day

**Alumil**  **SMARTIA**  
S350



# CONTENTS

## **SMARTIA S350**

DESIGN PHILOSOPHY & CHARACTERISTICS	4
SENSE OF FREEDOM	8
ATTENTION TO DETAIL	12
EXPLOITING EVERY CONTEMPORARY NEED	14
SECTIONS	16
INSTALLATION	28
APPLICATIONS	32
PERFORMANCE	33
REFERENCE PROJECTS	34



### **SMARTIA S350**

is distinguished by the slim design and light profiles combined with substantial thermal insulation and high certified performances.

**Slim lines,  
effortless operation**

SMARTIA S350  
is a flexible insulated  
sliding system ...

with a **modern flat design**. It is ideal  
for refurbishments or renovations  
thanks to its **construction easiness**.



- Basic system depth 35 mm.
- Maximum visibility and natural light with only 25 mm width at the interlocking profile.
- Easy access with low threshold ideal for renovations (version SMARTIA S350 LT).
- High thermal insulation with special sash available using anti-distortion polyamides, ideal for dark frames.
- Smooth and easy gliding, thanks to inox rails.
- Wide variety of typologies, compatible with various mechanisms.

**Alumil** SMARTIA  
S350



## TECHNICAL

## CHARACTERISTICS



VISIBLE ALUMINIUM FACE WIDTH	101 / 116 mm
FRAME HEIGHT	32 / 38 mm
FRAME WIDTH	92 mm
SASH HEIGHT	76 / 85 mm
SASH WIDTH	35 mm
INTERLOCKING PROFILE WIDTH	25 / 50,5 / 88,5 mm
SASH WEIGHT	UP TO 180 KG
GLAZING	18 UP TO 28 mm
THERMAL INSULATION	POLYAMIDES 24 mm, PVC

# SENSE

# OF FREEDOM

The ideal combination of **elegant appearance**, seamless functionality and ease of construction.

**ALTERNATIVE VERSION WITH LOW THRESHOLD:**  
for safe and easy access perfect for renovations.

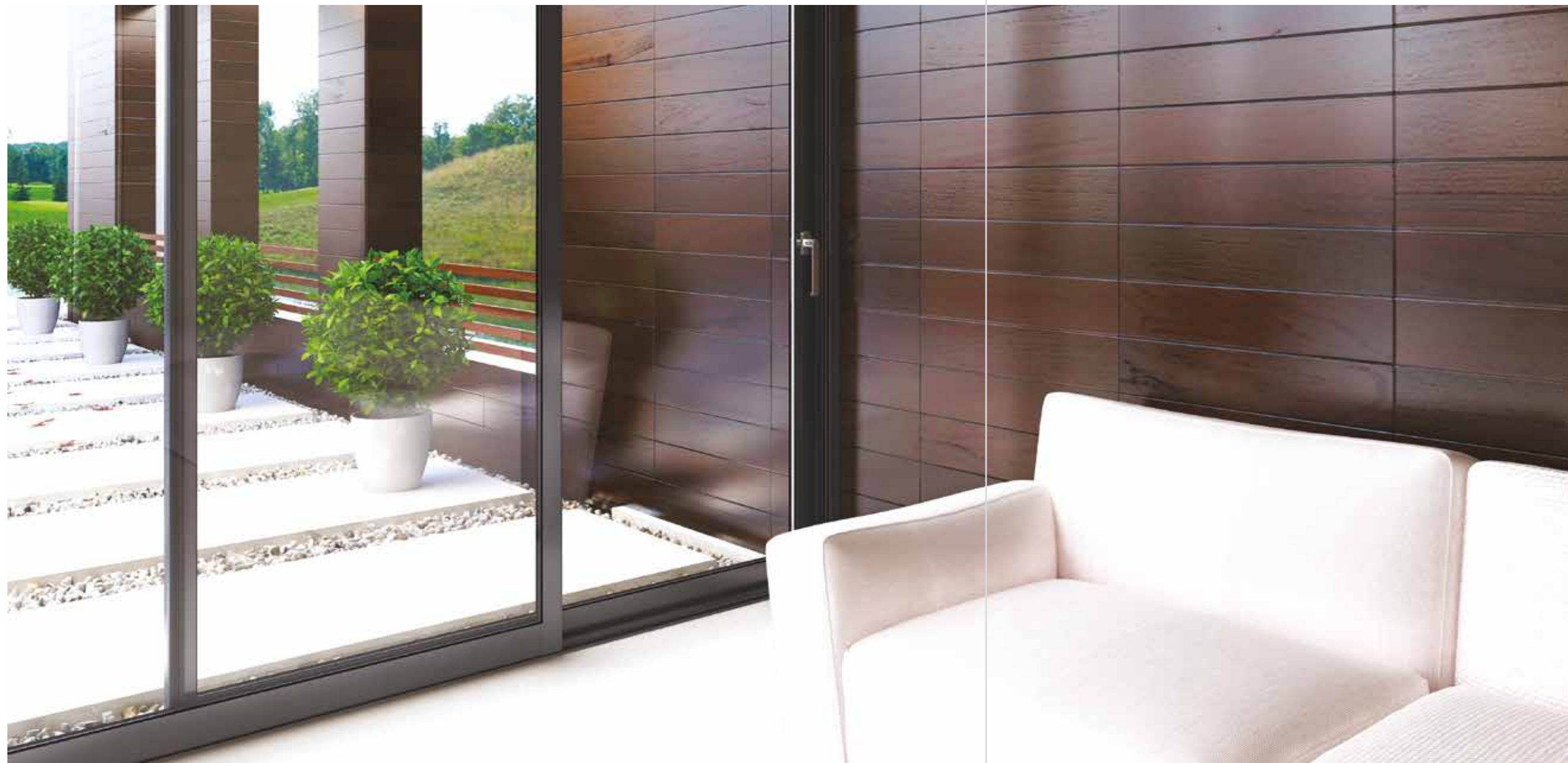

LOW THRESHOLD SMARTIA S350 LT



STANDARD THRESHOLD SMARTIA S350

**Minimal design** that enhances visibility...

and natural light with only **25 mm** width at the interlocking profile.



Available interlocking profile with **integrated reinforcement** empowers the construction against high wind pressures.

**Alumil** SMARTIA  
S350

## ATTENTION

## TO DETAIL

High thermal insulation is achieved with **fiberglass reinforced polyamides**.

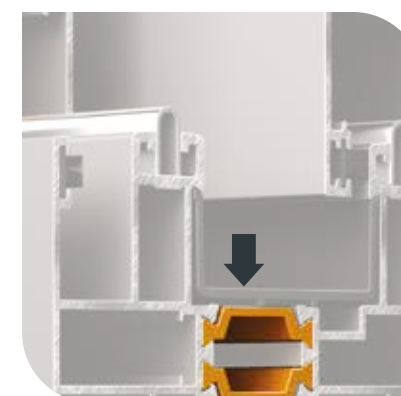

Available sash with special **anti-distortion polyamides** minimizes potential malfunctions caused by high-temperature fluctuations.

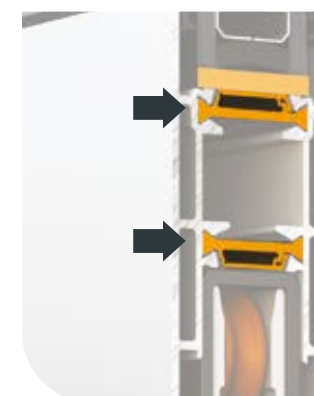

**High quality brushes** with **triple membrane** perimetrically of the sash, enhance the air permeability and watertightness.

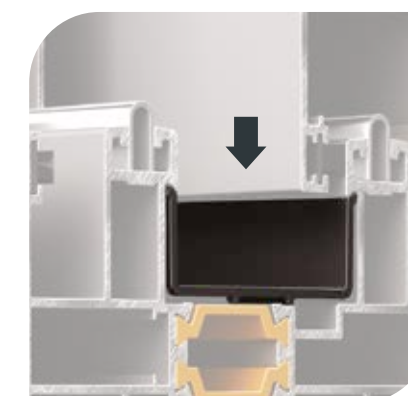
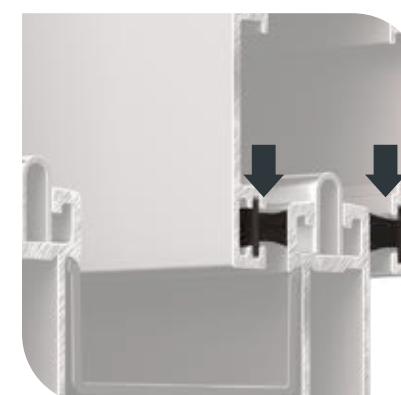

The **UV protected PVC profiles** for the track reduce the visible depth/complexity and contributes to the thermal insulation.

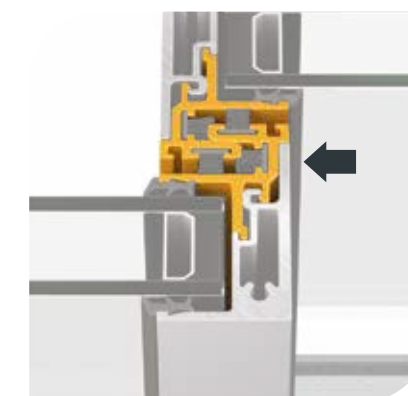

The specially designed **PVC profiles for the narrow interlocking profile** optimize air permeability and thermal insulation, enhancing energy saving.

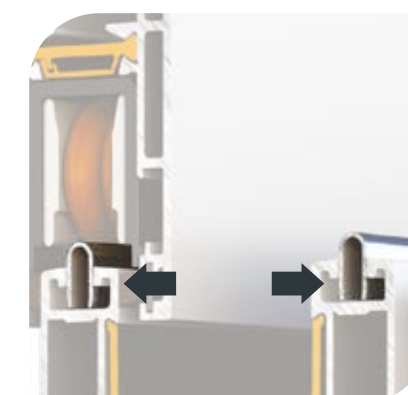

The sash glides **easily and quietly** on the rails made of stainless steel AISI 316L.



SASH PROFILES				
	S384	S390	S35011	S35013
<b>TRACK PROFILE</b>				
STANDARD THRESHOLD	•	•	•	•
LOW THRESHOLD	•	•	•	•
<b>INTERLOCKING PROFILE</b>				
NARROW 25 mm			•	
NARROW 50,5 mm	•	•		
STANDARD	•	•	•	•
<b>ADJOINING PROFILE</b>				
NARROW	•	•		
STANDARD	•	•	•	•
<b>GLAZING WIDTH</b>				
18 - 26 mm	•	•	•	•
28 mm			•	

## EXPLOITING

## EVERY CONTEMPORARY NEED

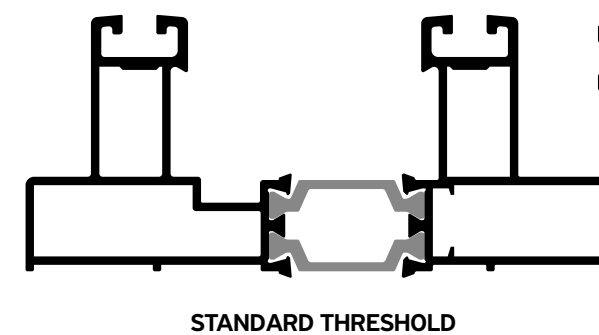
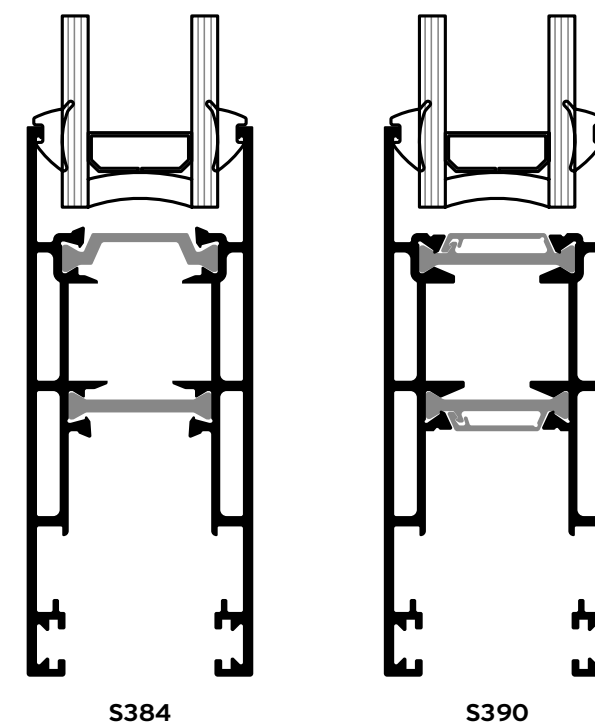
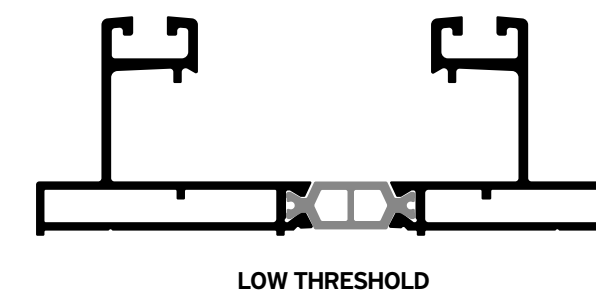
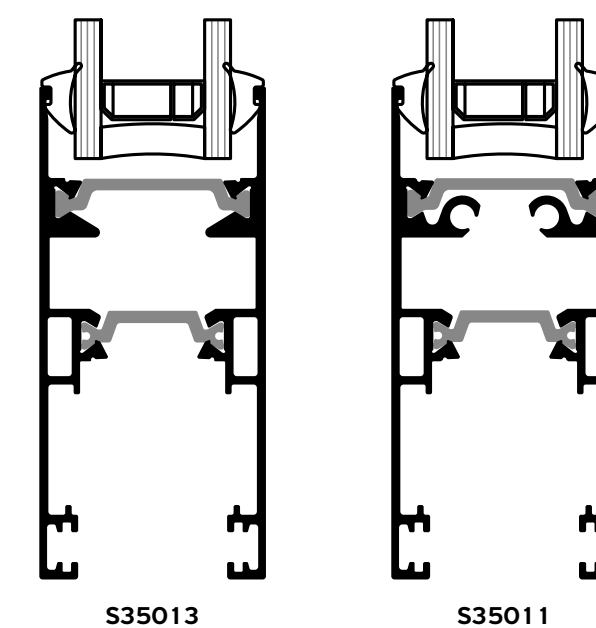
 ▶ SMARTIA  
S350

 ▶ SMARTIA  
S350 LT

**Alumil** SMARTIA  
S350

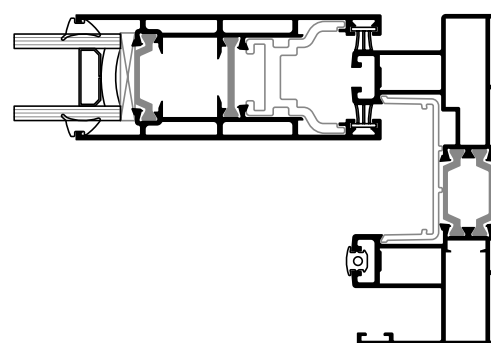
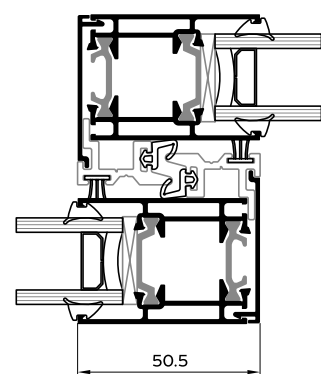
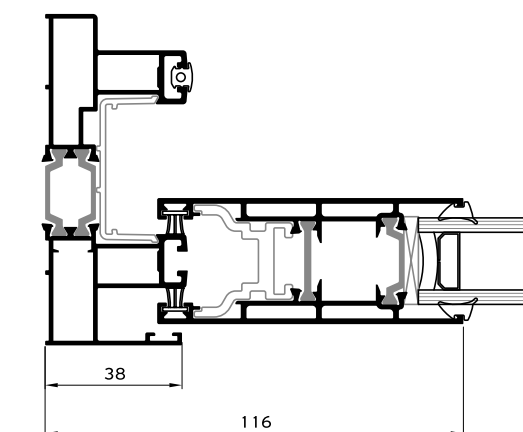
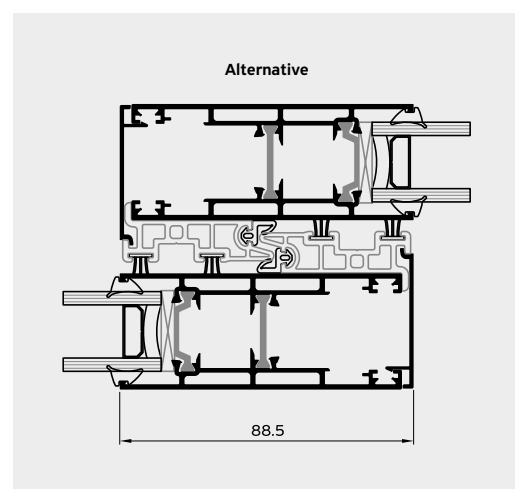
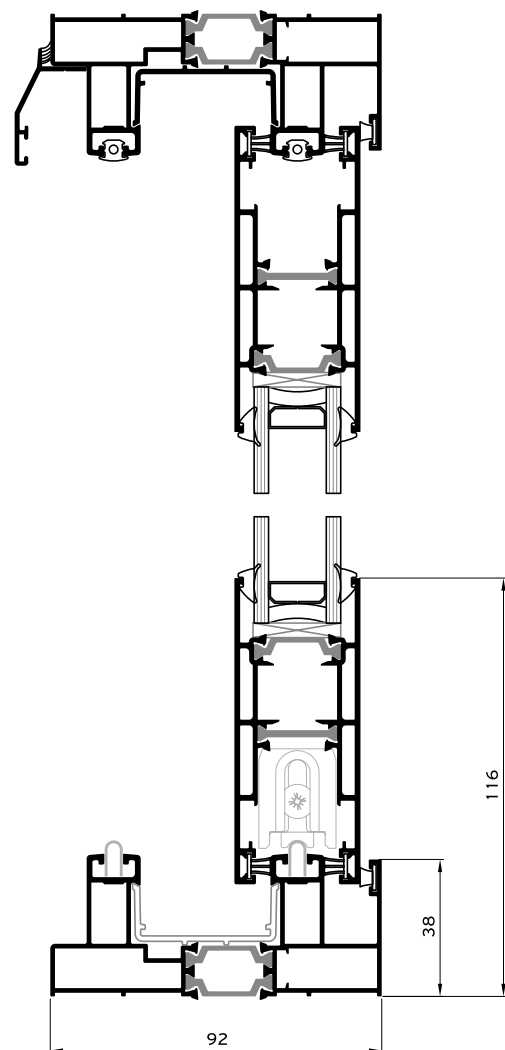
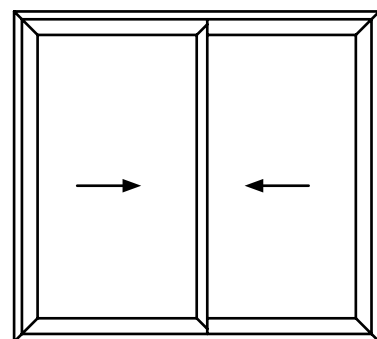
**2 Sashes / 2 Track**



**Alumil** SMARTIA  
S350 LT

**2 Sashes / 2 Track**  
**Low Threshold**

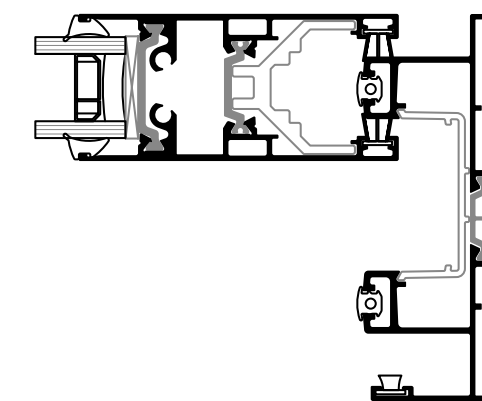
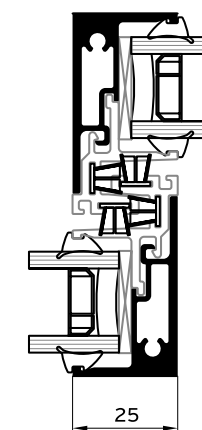
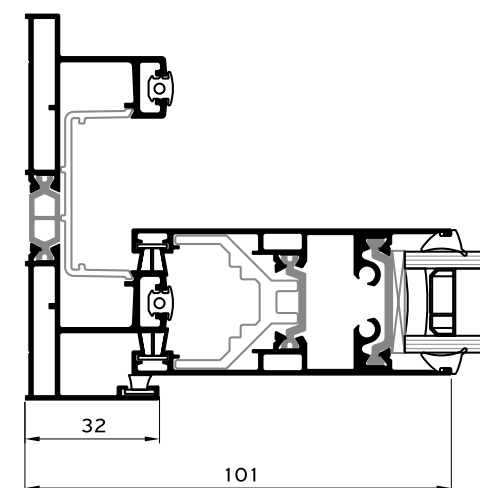
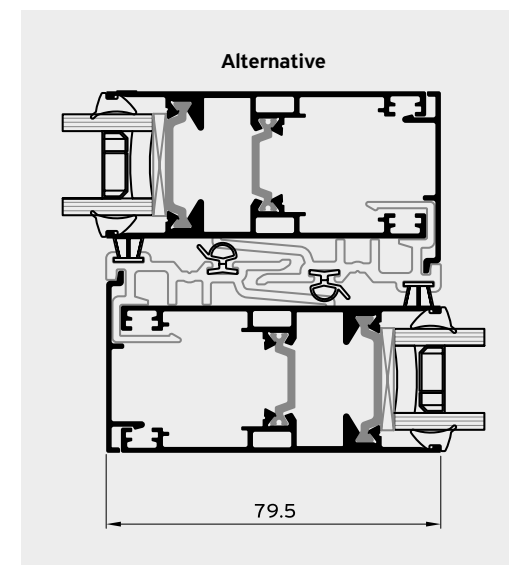
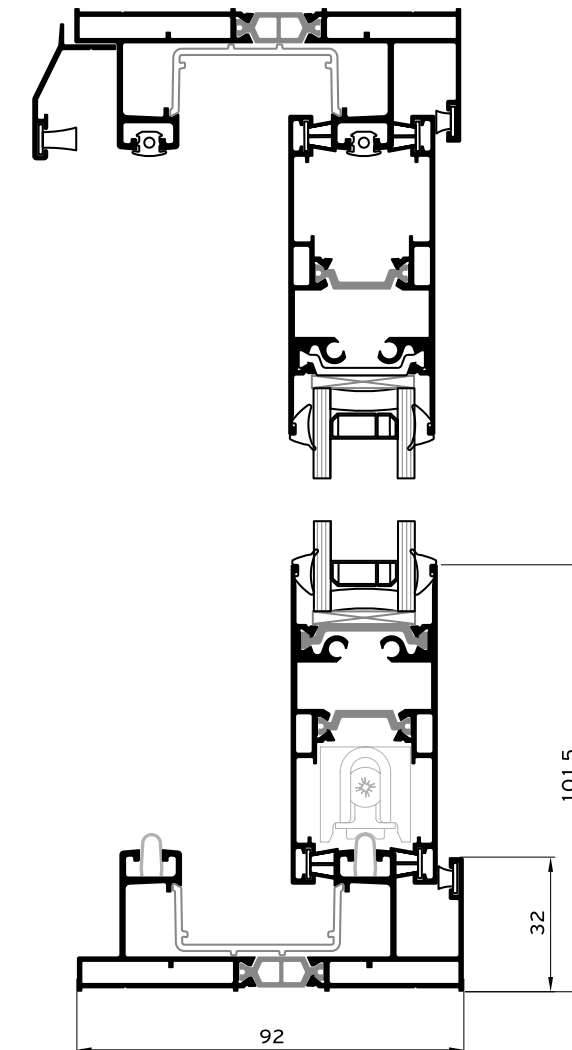
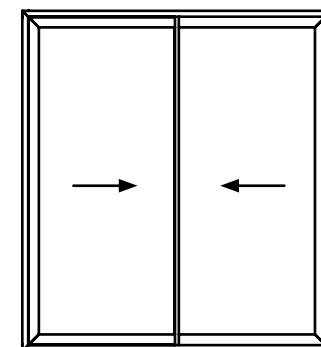

**Alumil** SMARTIA S350 2 Sashes / 2 Track / Flyscreen

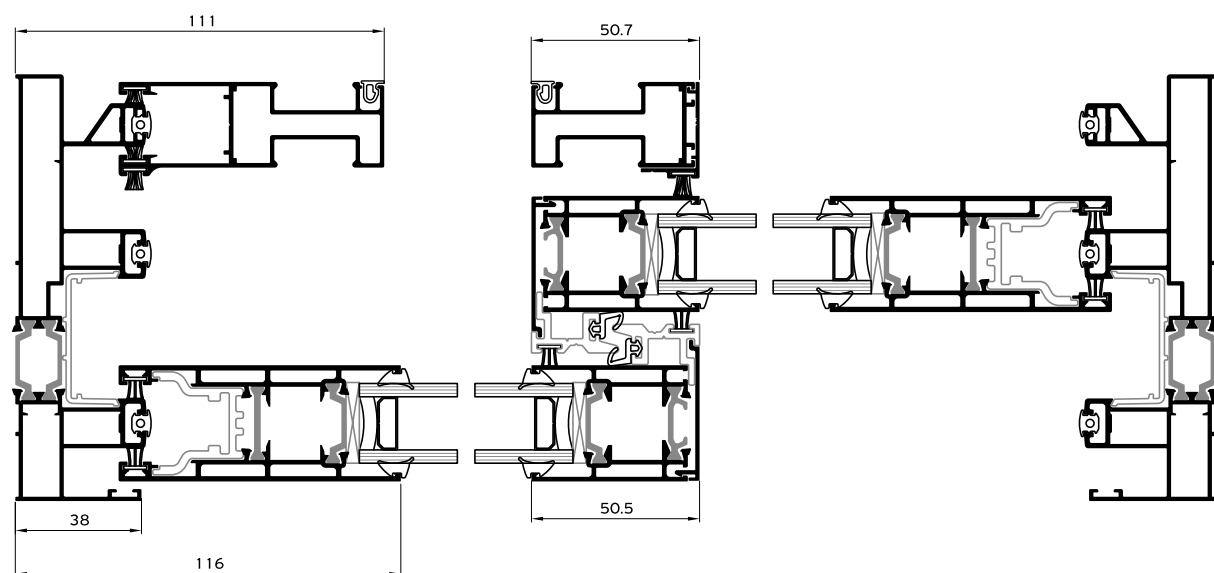
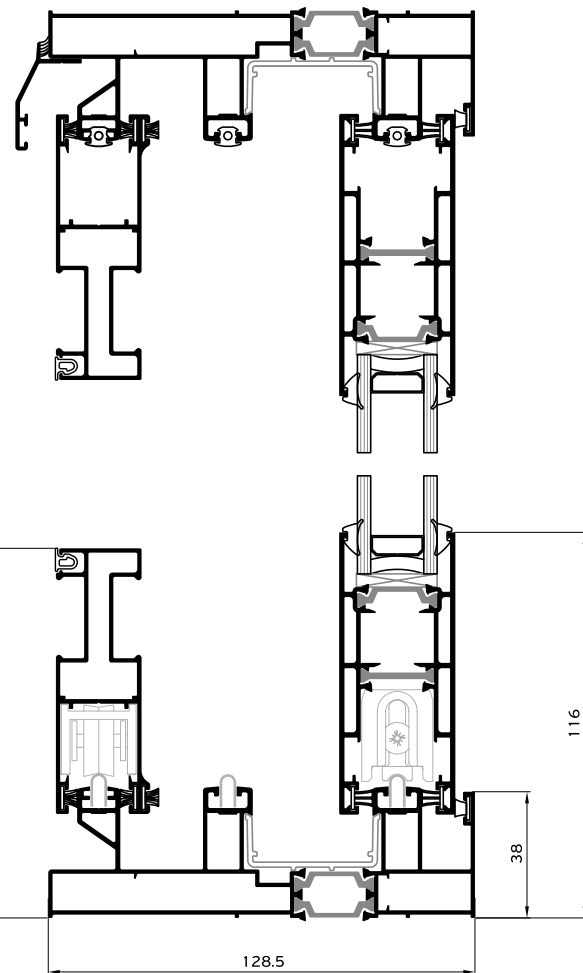
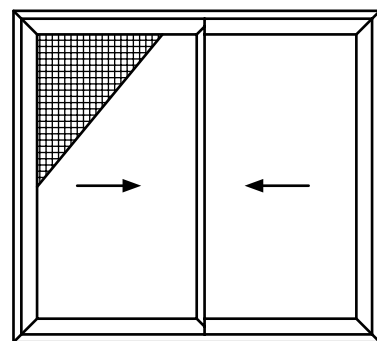

**Alumil** SMARTIA S350 LT 2 Sashes / 2 Track / Flyscreen Low Threshold

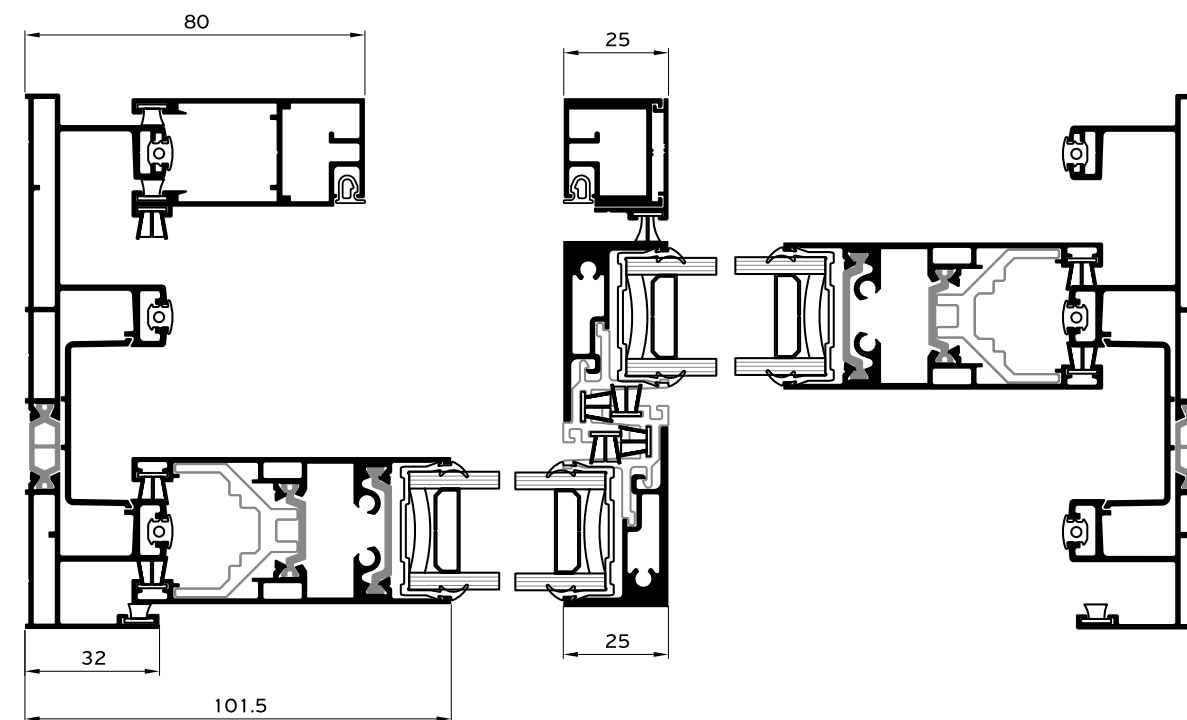
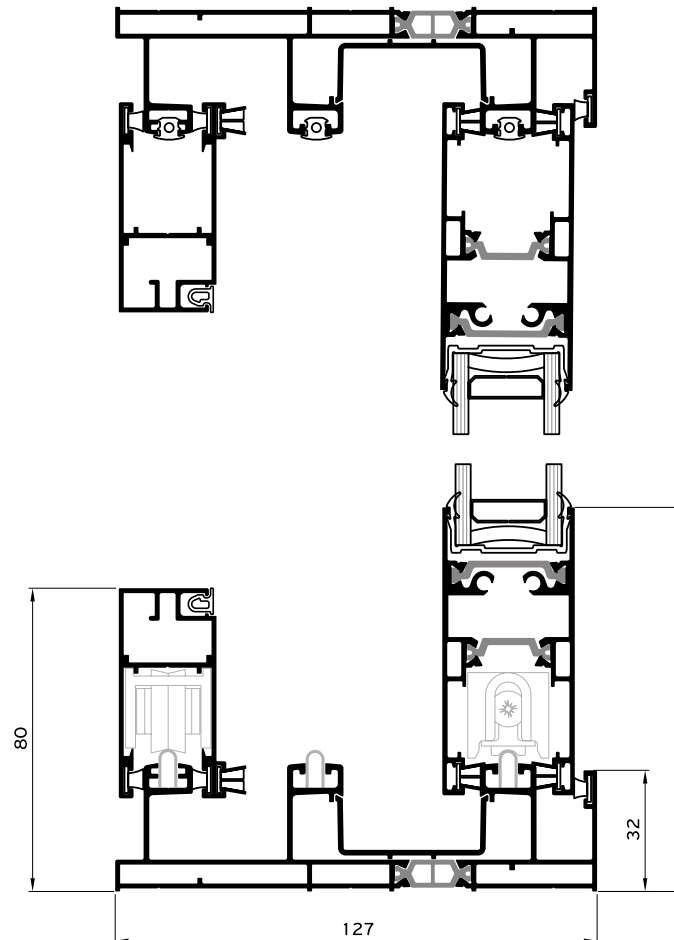
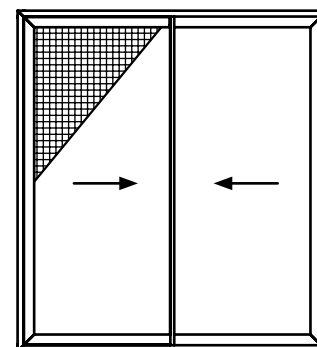

**Alumil** SMARTIA  
S350

**3 Sashes / 3 Track**

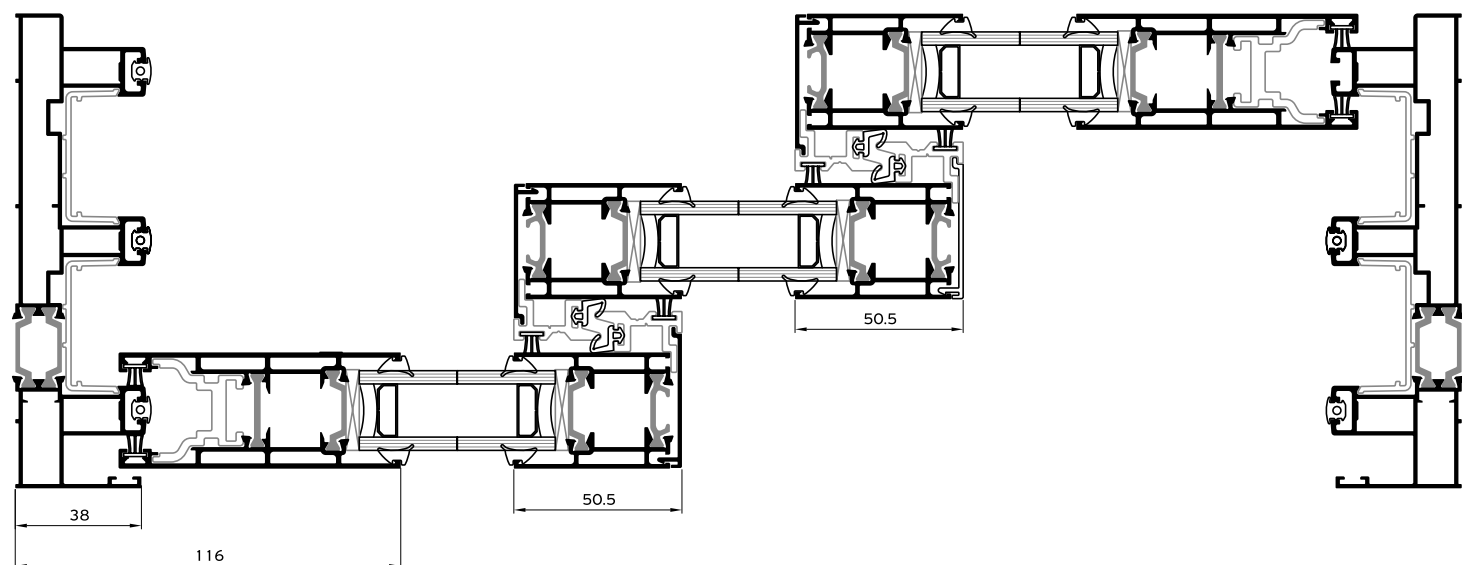
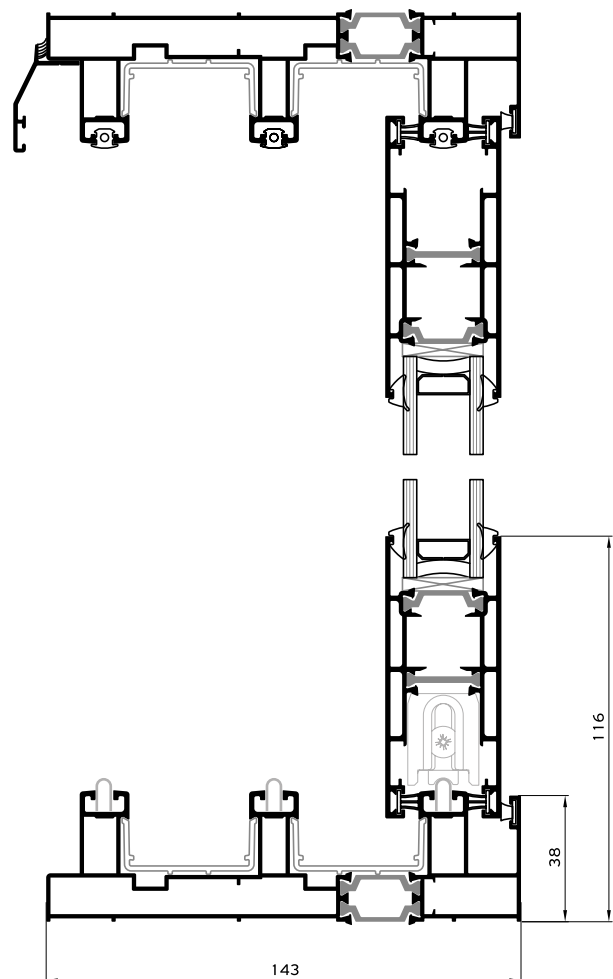
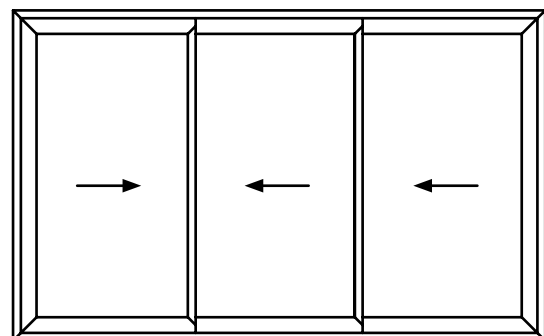

**Alumil** SMARTIA  
S350 LT

**3 Sashes / 3 Track**  
Low Threshold

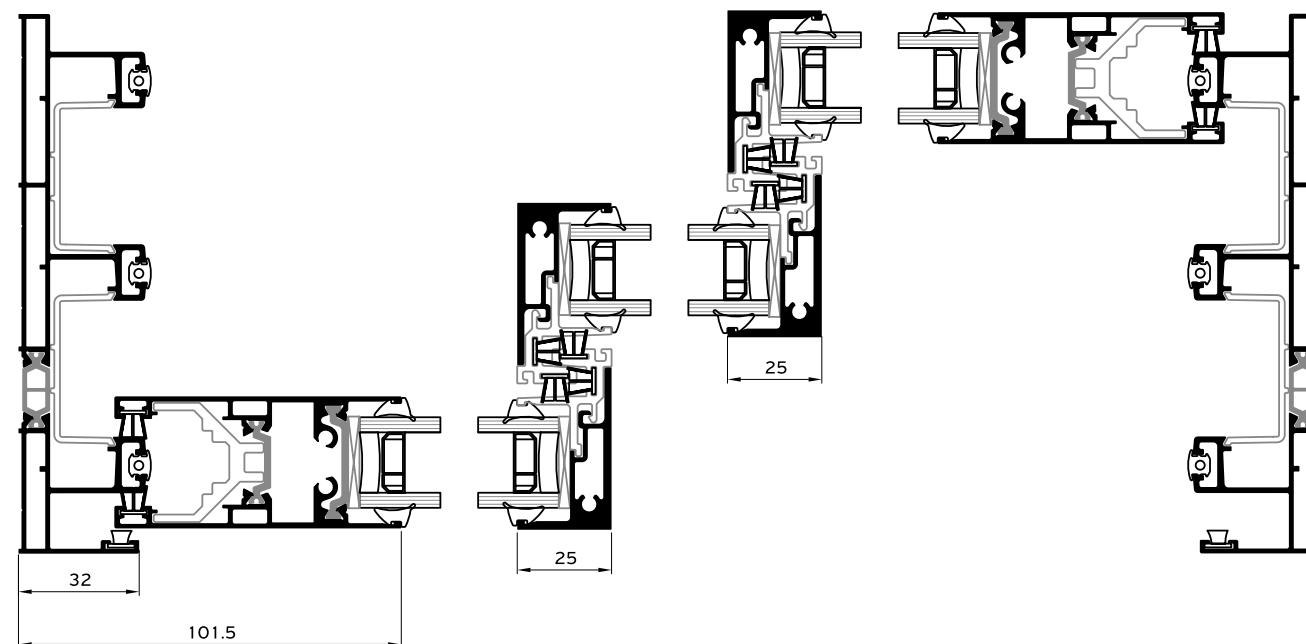
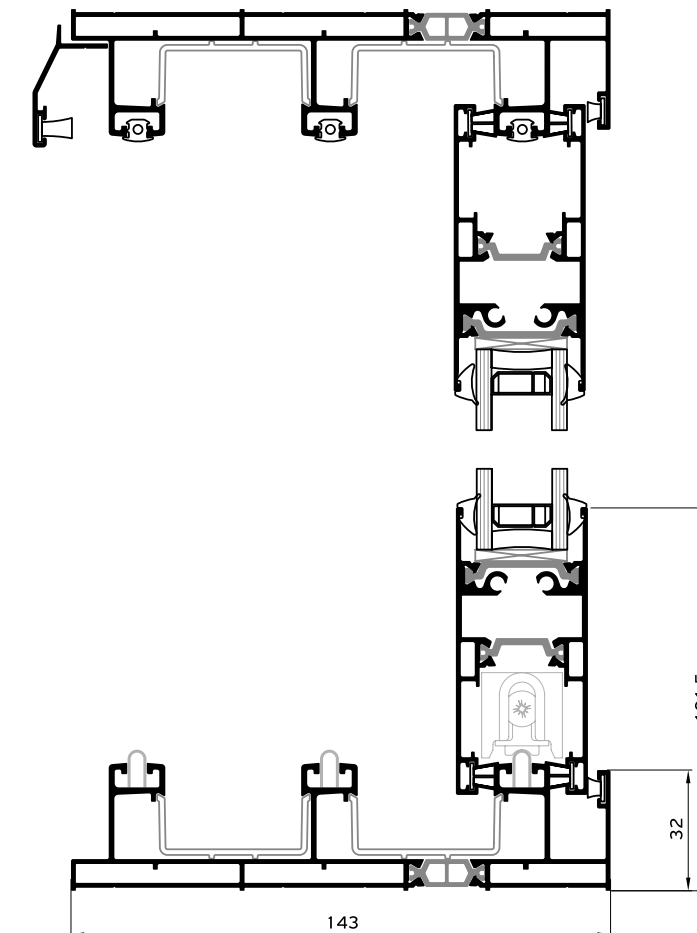
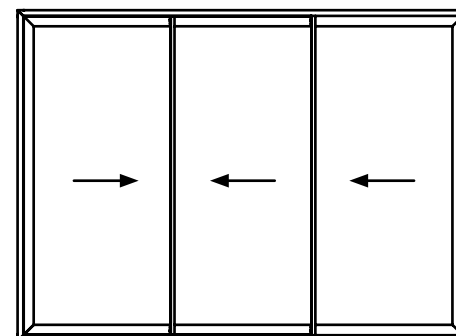

**Alumil** SMARTIA  
S350

**4 Sashes / 2 Track**

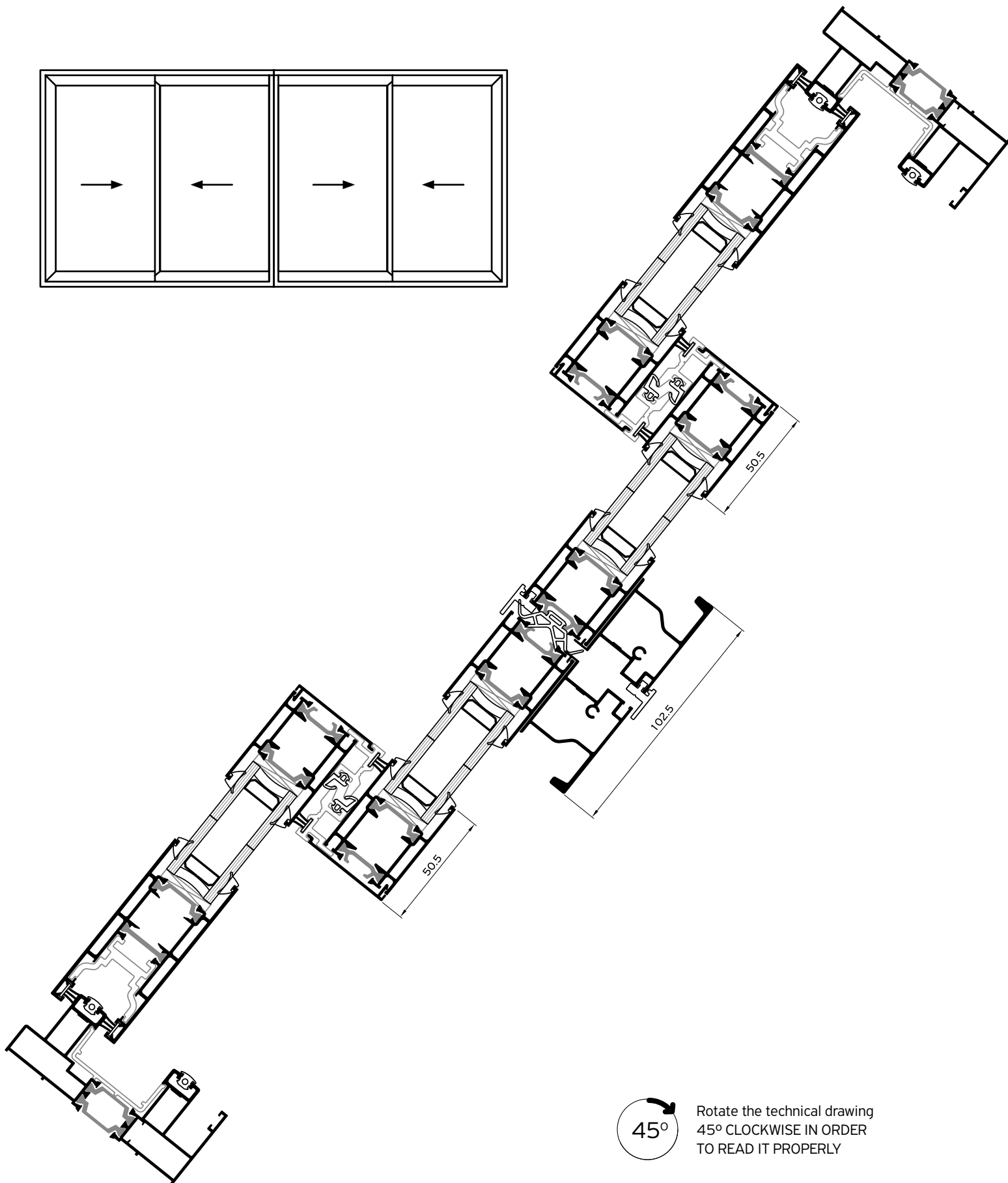
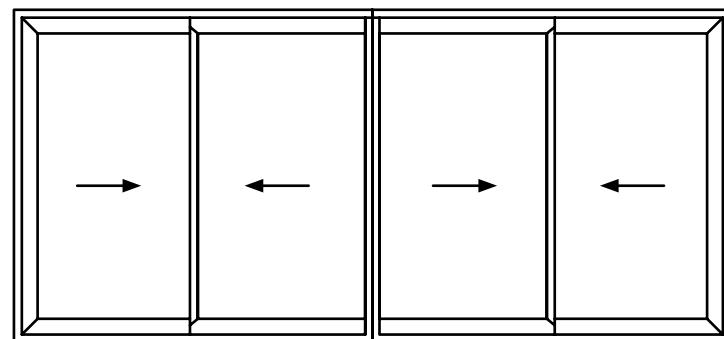

45° Rotate the technical drawing  
45° CLOCKWISE IN ORDER  
TO READ IT PROPERLY

**Alumil** SMARTIA  
S350 LT

**4 Sashes / 2 Track**  
Low Threshold

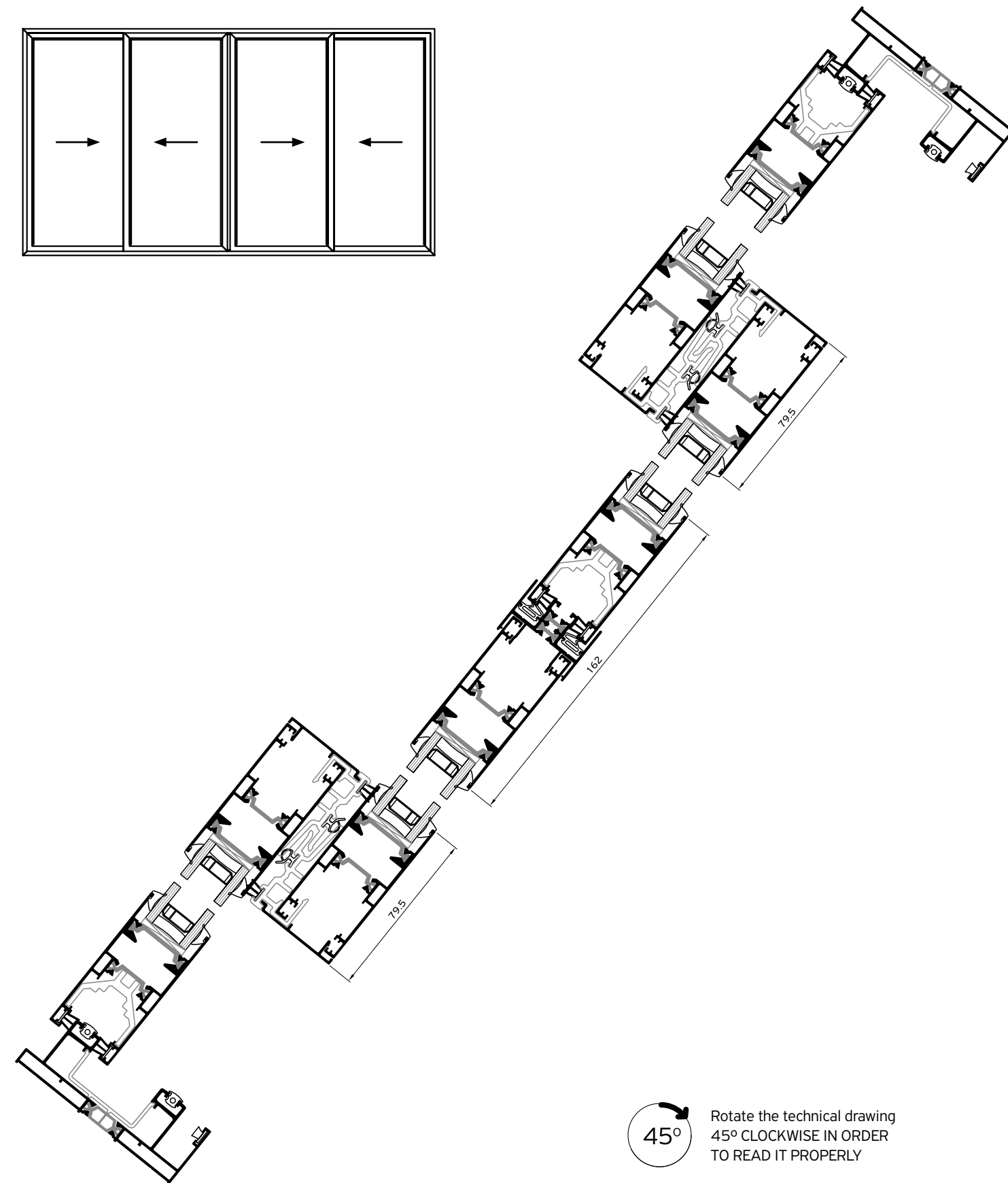
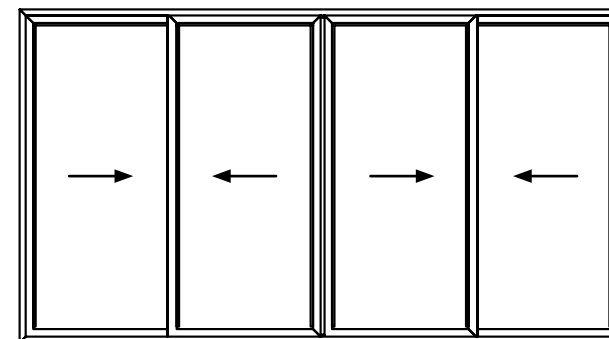

45° Rotate the technical drawing  
45° CLOCKWISE IN ORDER  
TO READ IT PROPERLY

**Alumil** SMARTIA  
S350

**POCKET WINDOW**  
2 Sashes / 1 Track  
Flyscreen / Shutter

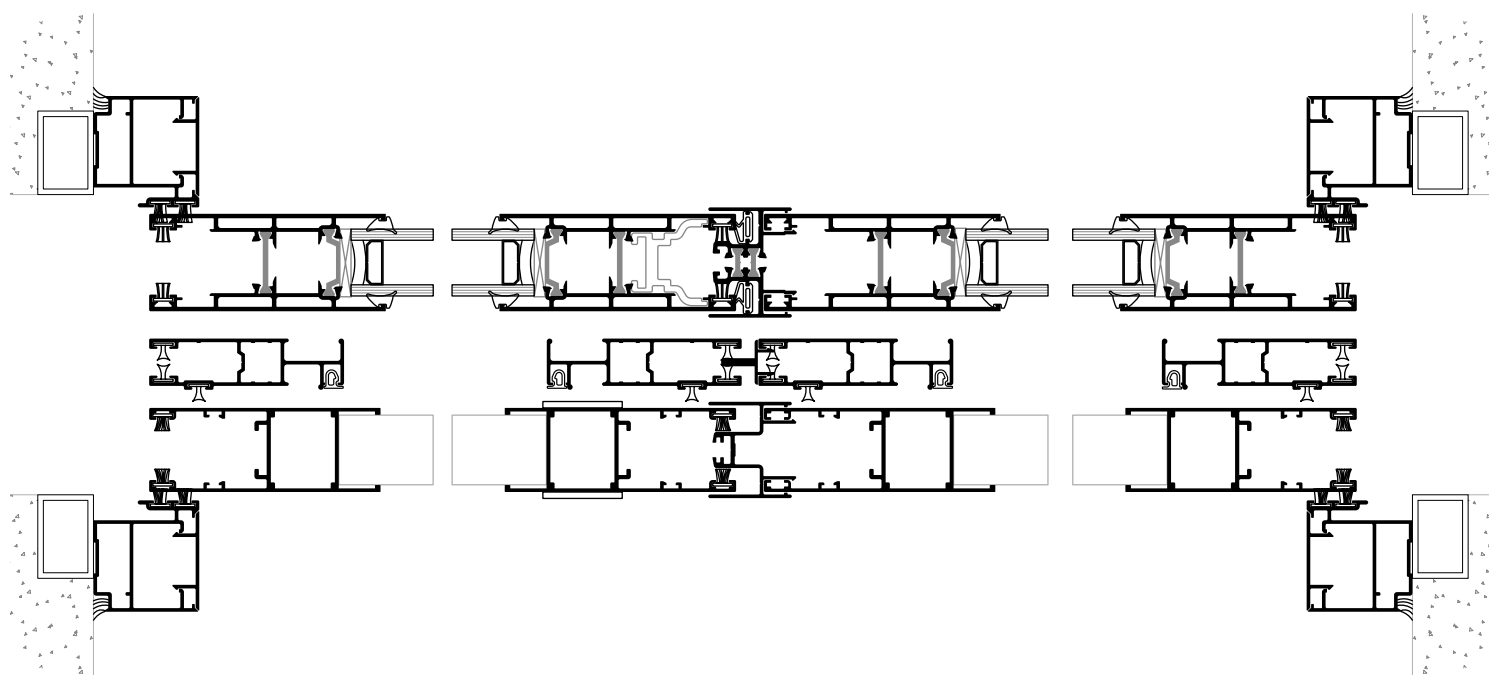
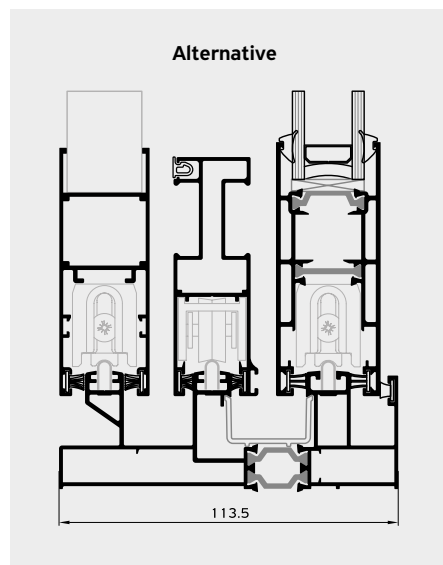
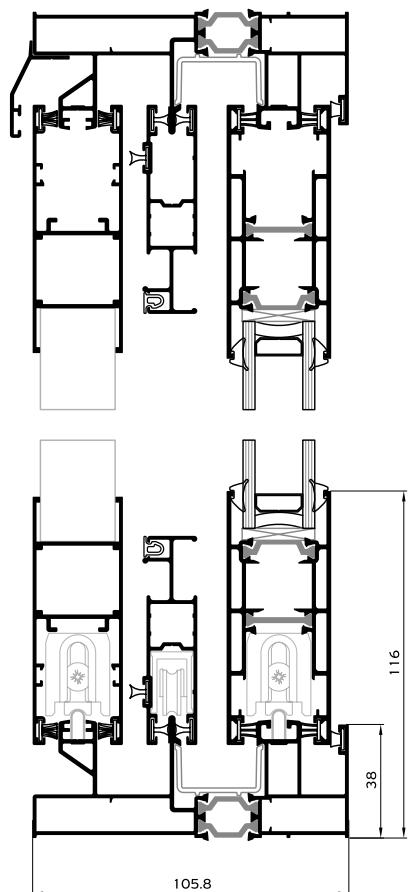
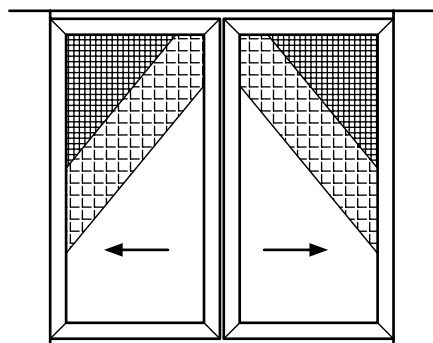

**Alumil** SMARTIA  
S350 LT



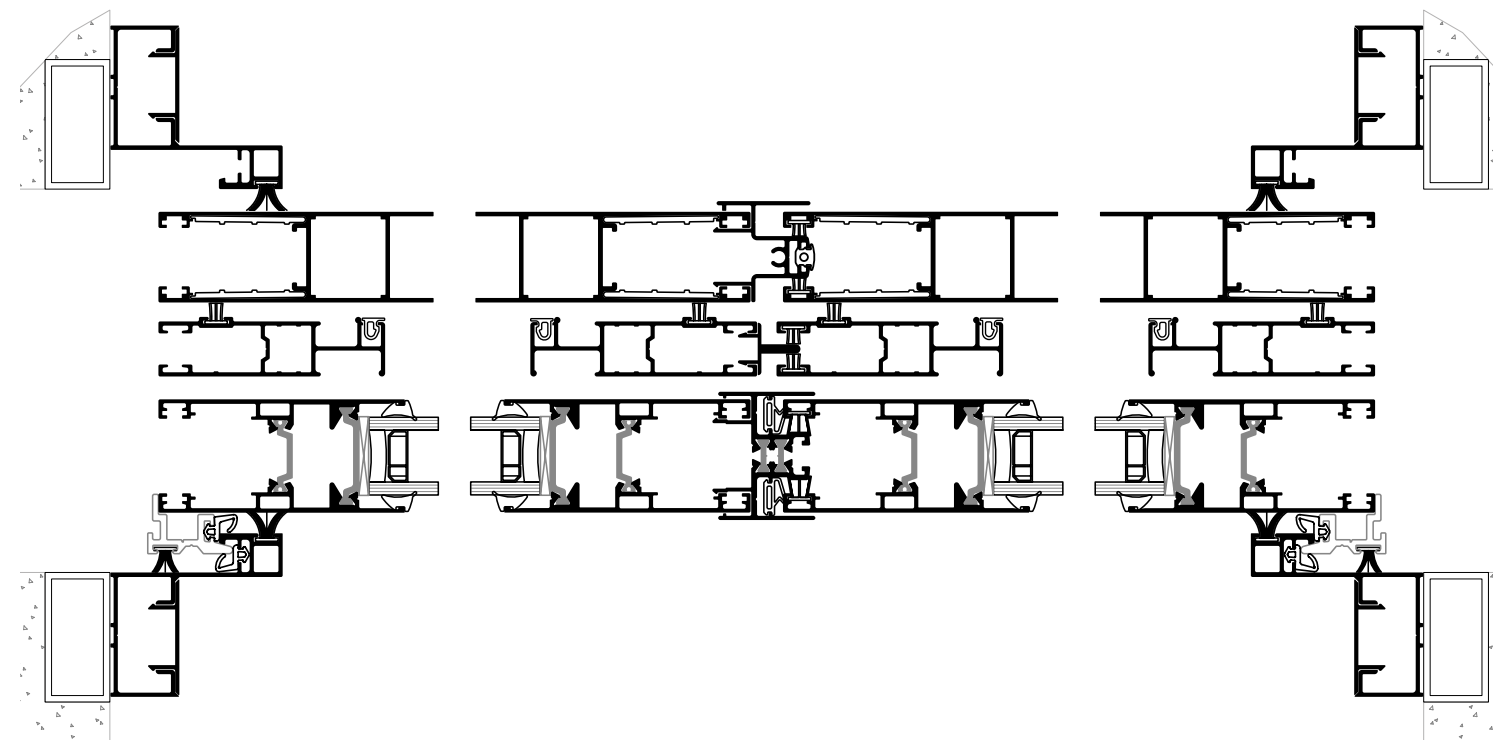
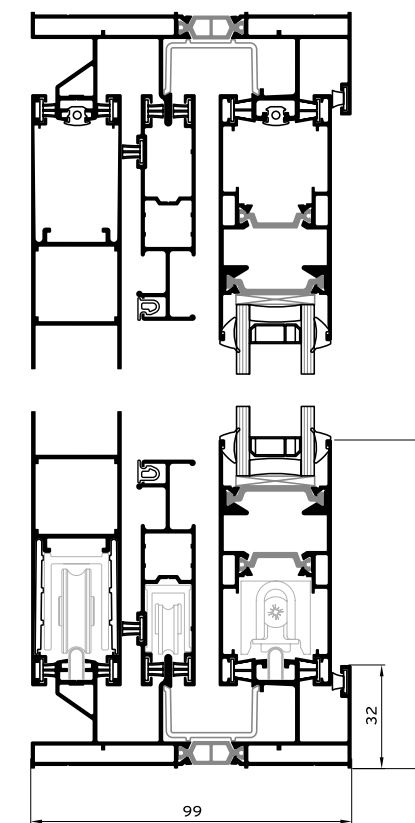
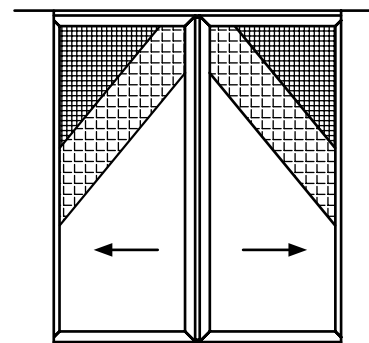



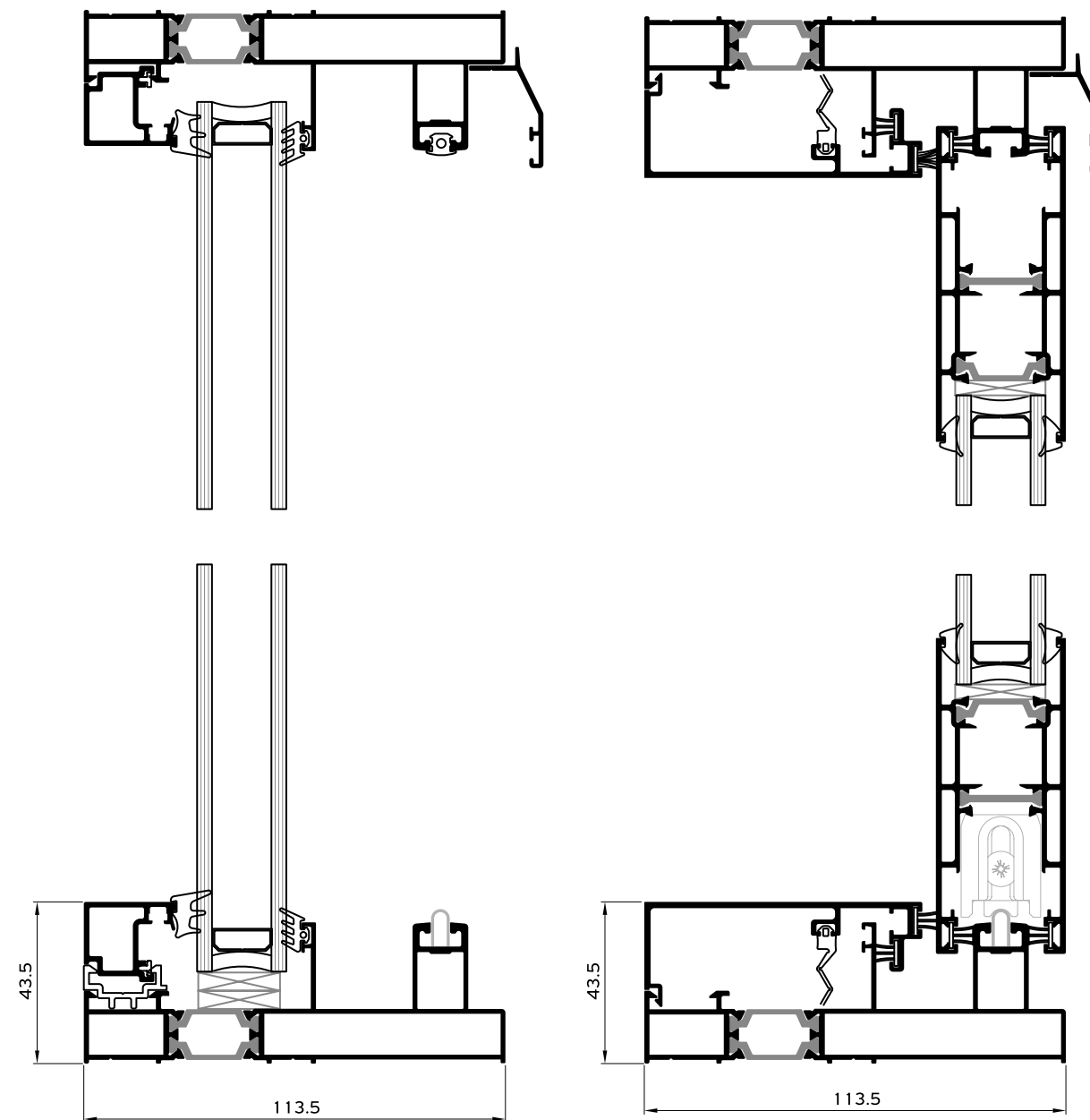
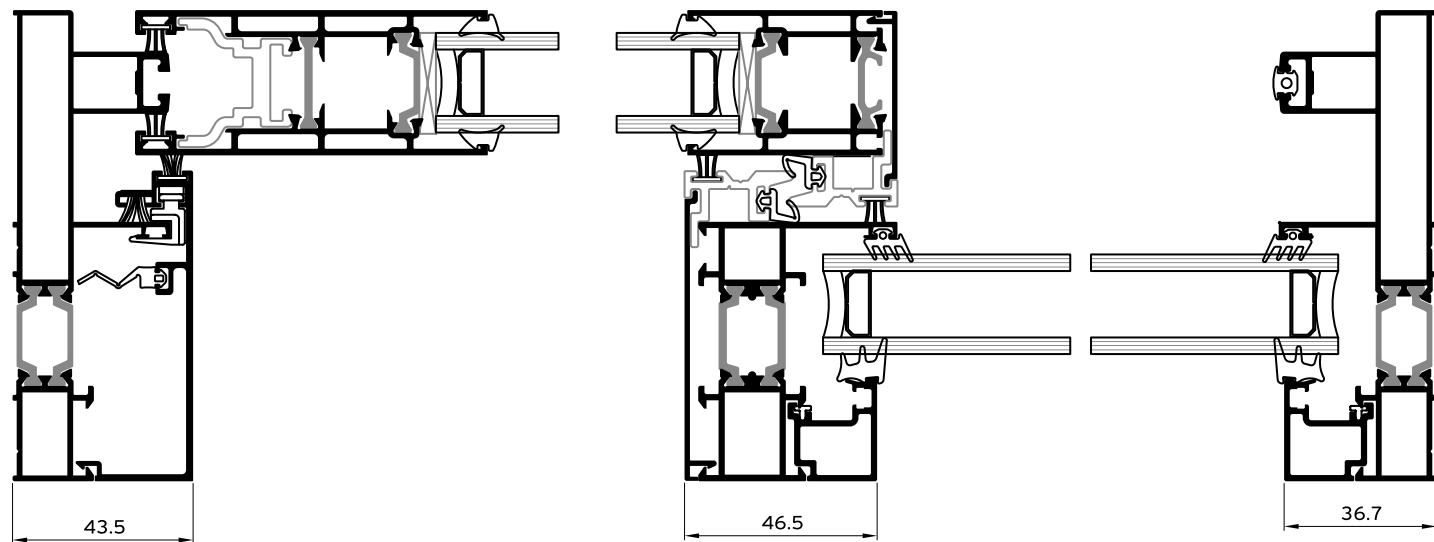
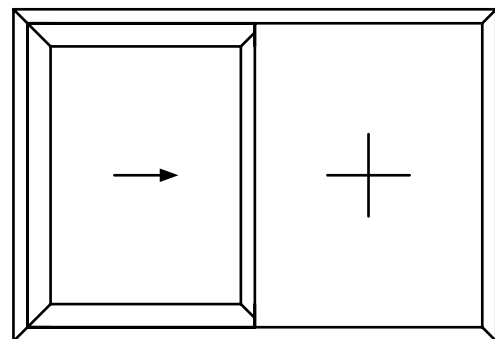

**POCKET WINDOW**  
2 Sashes / 1 Track  
Flyscreen / Shutter  
Low Threshold

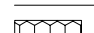

1 Sash / Fixed Light

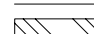
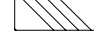

# Installation

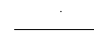
-  PRECOMPRESSED MULTI-FUNCTION SEALING TAPE
-  BACKER ROD
-  HYBRID SEALANT OR NEUTRAL SILICONE
-  STYRODUR HIGH DENSITY BOARD
-  MARBLE
-  POLYURETHANE FOAM
-  POLYSTYRENE
-  WALL CONSTRUCTION
-  WALL FINISH
-  REINFORCED CONCRETE
-  AIR WATER VAPOR BARRIER TAPE

SIDE SECTION

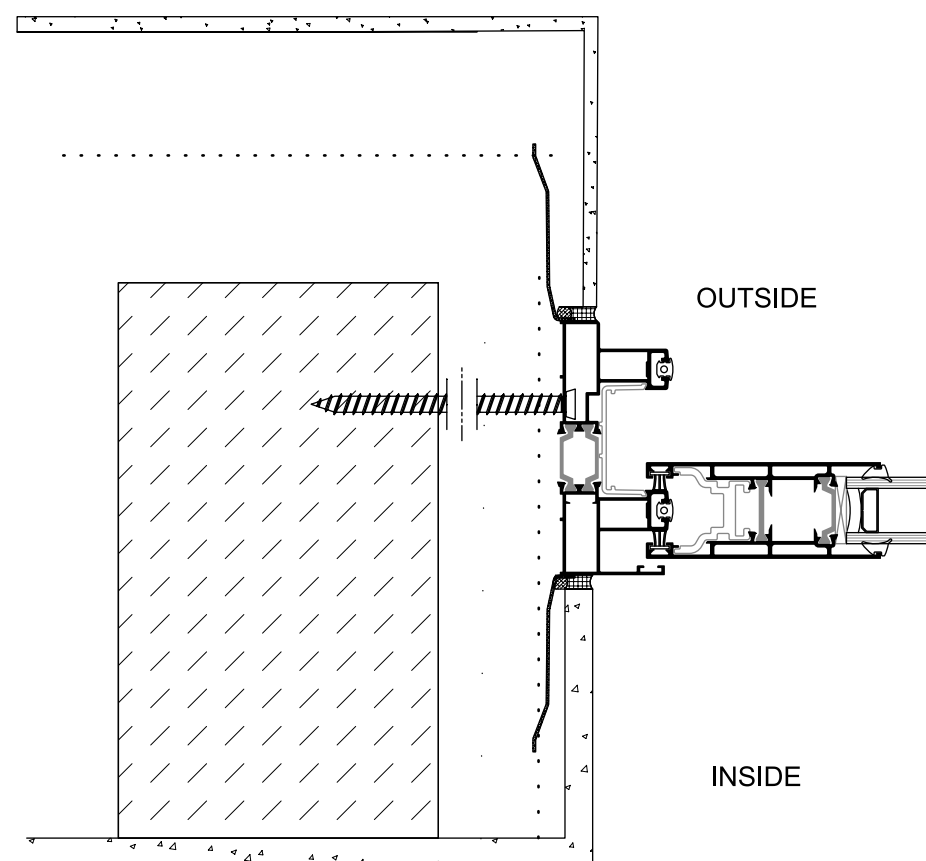

TOP SECTION

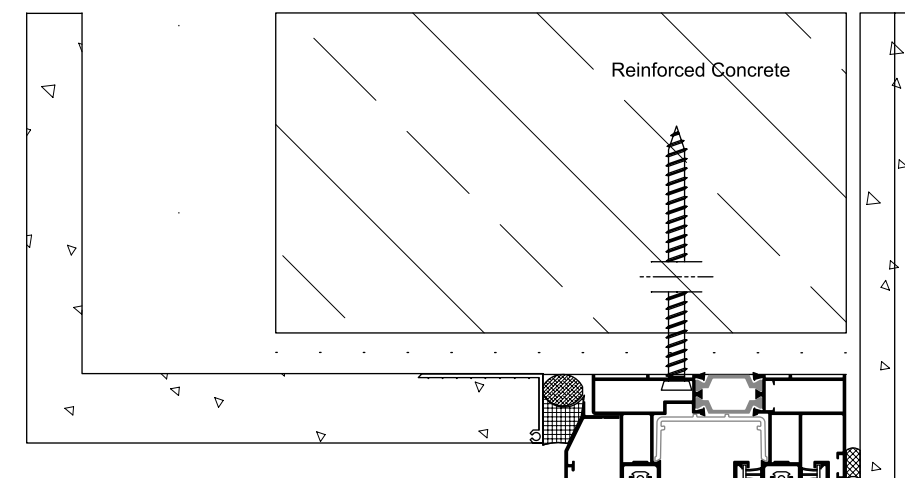

OUTSIDE



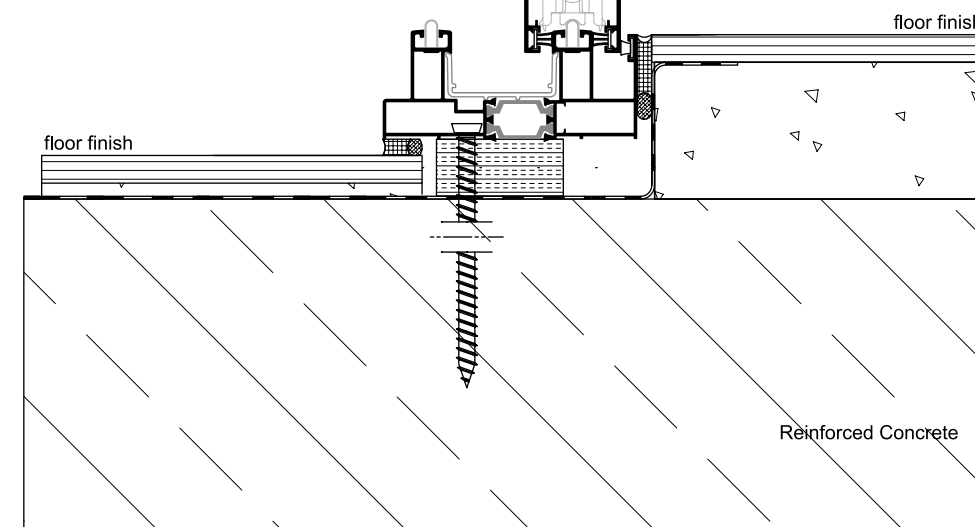





INSIDE

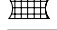
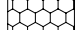

BOTTOM SECTION

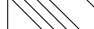

# Installation

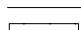
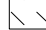
-  PRECOMPRESSED MULTI-FUNCTION SEALING TAPE
-  BACKER ROD
-  HYBRID SEALANT OR NEUTRAL SILICONE
-  STYRODUR HIGH DENSITY BOARD
-  MARBLE
-  POLYURETHANE FOAM
-  POLYSTYRENE
-  WALL CONSTRUCTION
-  WALL FINISH
-  REINFORCED CONCRETE
-  AIR WATER VAPOR BARRIER TAPE

SIDE SECTION

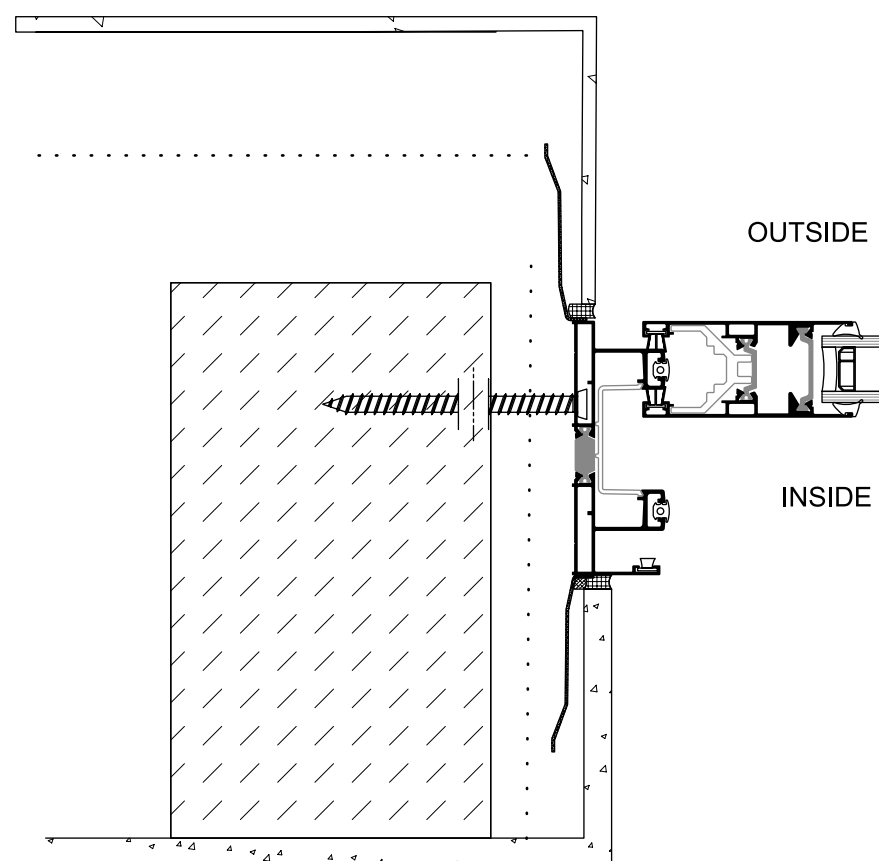

TOP SECTION

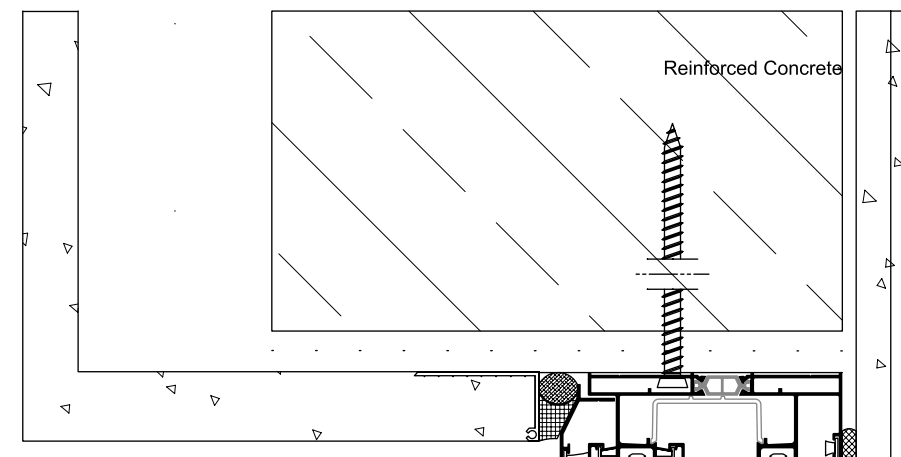

OUTSIDE

INSIDE

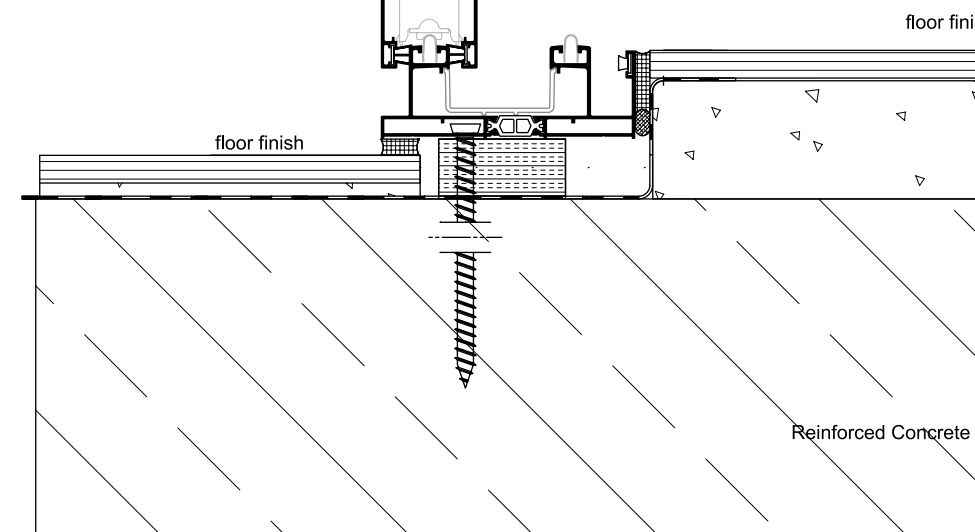

BOTTOM SECTION

# Applications

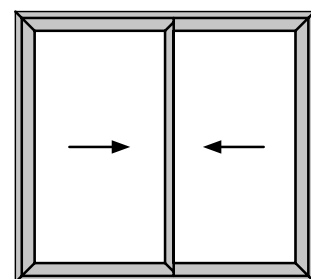

2 SASHES / 2 TRACK

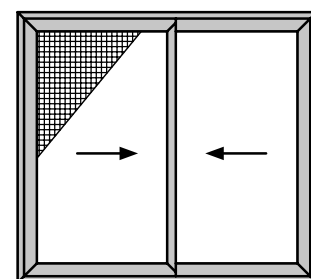

2 SASHES / 2 TRACK / FLYSCREEN

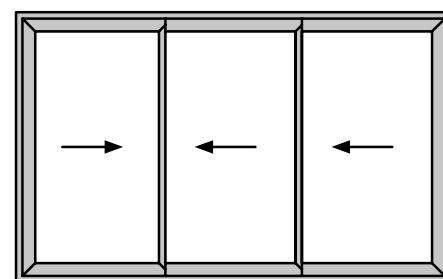

3 SASHES / 3 TRACK

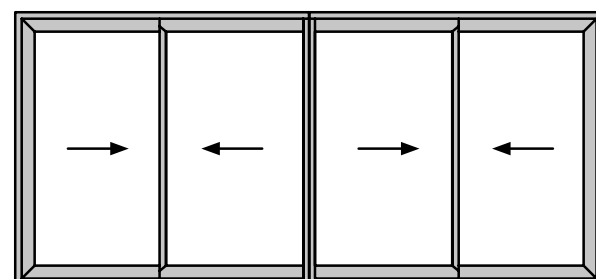

4 SASHES / 2 TRACK

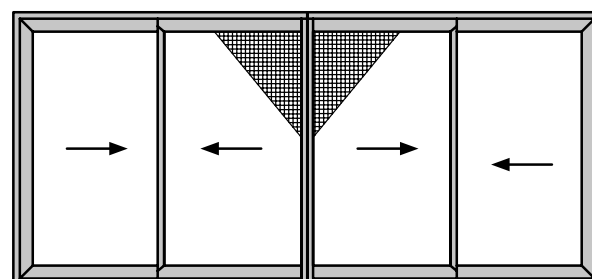

4 SASHES / 2 TRACK / FLYSCREEN

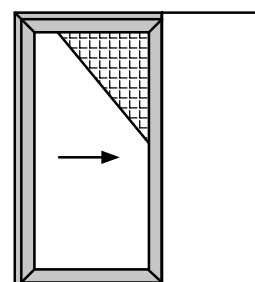

POCKET WINDOW  
1 SASH / 1 TRACK / SHUTTER

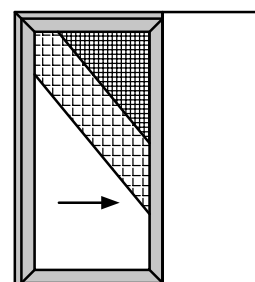

POCKET WINDOW  
1 SASH / 1 TRACK / FLYSCREEN / SHUTTER

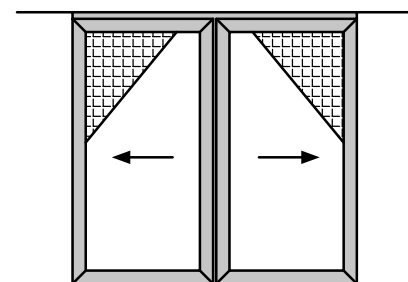

POCKET WINDOW  
2 SASHES / 1 TRACK / SHUTTER

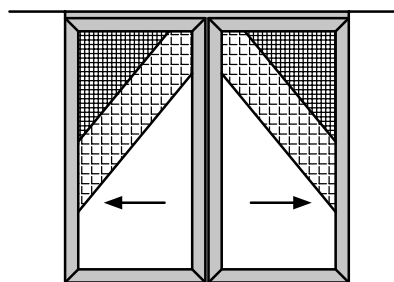

POCKET WINDOW  
2 SASHES / 1 TRACK / FLYSCREEN / SHUTTER

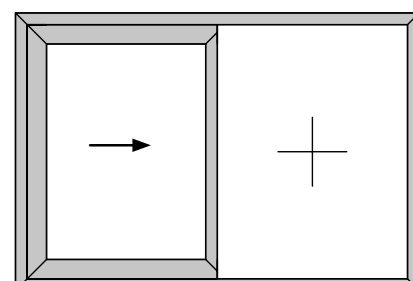

1 SASH / FIXED LIGHT

# Table of performance

## CERTIFICATION



**WATER TIGHTNESS**  
EN 12208



**AIR PERMEABILITY**  
EN 12207



**WIND LOAD RESISTANCE**  
MAX TEST PRESSURE  
EN 12210



**WIND LOAD RESISTANCE**  
TO FRONTAL DEFLECTION  
EN 12210



**SOUND REDUCTION**  
EN 10140, EN 717

## CLASSIFICATION

1A (0 Pa)	2A (50 Pa)	3A (100 Pa)	4A (150 Pa)	5A (200 Pa)	6A (250 Pa)	<b>7A</b> <b>(300 Pa)</b>	8A (450 Pa)	9A (600 Pa)
1 (150 Pa)		2 (300 Pa)		3 (600 Pa)		<b>4</b> <b>(600 Pa)</b>		
1 (400 Pa)		<b>2</b> <b>(800 Pa)</b>	3 (1200 Pa)		4 (1600 Pa)		5 (2000 Pa)	
A (≤ 1/150)				B (≤ 1/200)			<b>C</b> <b>(≤ 1/300)</b>	
38 dB								

ALUMIL has also certified the system SMARTIA S350 according to ASTM standards which are available upon request.

## THERMAL PERFORMANCE

	DIMENSIONS IN MM (W x H)	U <sub>w</sub> in W/m <sup>2</sup> K (U <sub>g</sub> = 0,8)	U <sub>w</sub> in W/m <sup>2</sup> K (U <sub>g</sub> = 1,0)	U <sub>w</sub> in W/m <sup>2</sup> K (U <sub>g</sub> = 1,1)
<b>S350 2 SASHES / 2 TRACK</b>	2300 x 2180	1,76	1,92	1,99
<b>S350 LT 2 SASHES / 2 TRACK</b>	2300 x 2180	1,75	1,91	1,99
<b>S350 4 SASHES / 2 TRACK</b>	4600 x 2180	1,71	1,87	1,95
<b>S350 LT 4 SASHES / 2 TRACK</b>	4600 x 2180	1,70	1,86	1,95



Cradle to Cradle Certified® is the global standard for products that are safe, circular and responsibly made

# REFERENCE PROJECTS

- 1. PRIVATE RESIDENCE / LEFKADA, GREECE
- 2. TRIANGLE STUDENT HALLS / NICOSIA, CYPRUS
- 3. CRONWELL RESORT SERMILIA / CHALKIDIKI, GREECE
- 4. CARAVIA BEACH HOTEL / KOS, GREECE
- 5. DOC - TEMPORARY FLOATING HOUSE / CALARASI, ROMANIA
- 6. PRIVATE RESIDENCE / SKIATHOS, GREECE



1

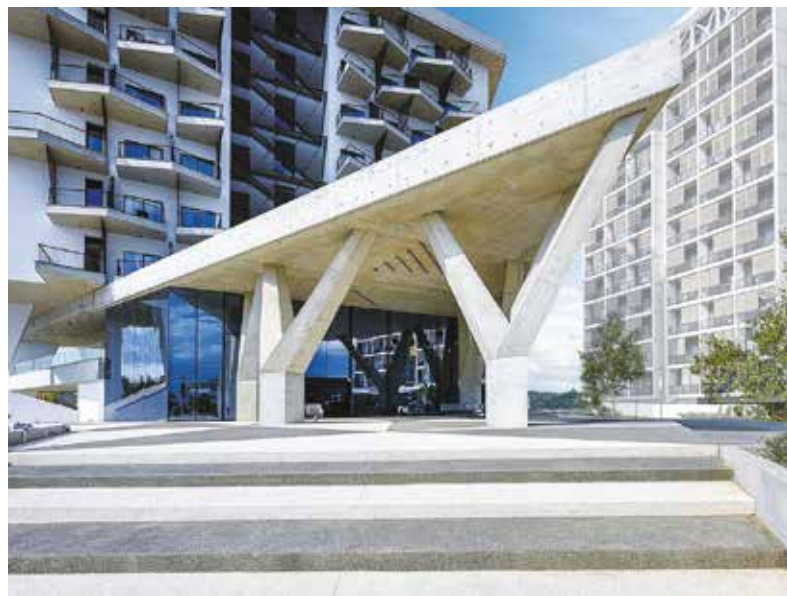

2



4



3



5



6

www.alumil.com

DISCOVER MORE:



**ALUMIL  
HEAD OFFICES  
& SHOWROOM - THESSALONIKI**

GOGOUSI 8, EFKARPIA  
THESSALONIKI - GR 56429  
TEL.: +30 2313011000  
FAX.: +30 231692473  
E-MAIL.: info@alumil.com

**ALUMIL  
HEADQUARTERS**

KILKIS INDUSTRIAL AREA  
KILKIS - GR 61100  
TEL.: +30 23410 79300  
FAX.: +30 23410 71988  
E-MAIL.: info@alumil.com



**ALUMIL  
HEAD OFFICES  
& SHOWROOM - THESSALONIKI**

GOGOUSI 8, EFKARPIA  
THESSALONIKI - GR 56429

TEL.: +30 2313 011000  
FAX.: +30 2310 692473  
EMAIL.: info@alumil.com

**ALUMIL  
HEADQUARTERS**

KILKIS INDUSTRIAL AREA  
KILKIS - GR 61100

TEL.: +30 23410 79300  
FAX.: +30 23410 71988  
EMAIL.: info@alumil.com

**[www.alumil.com](http://www.alumil.com)**

**alumil**

EN MAY 2023